



Typical Application: US Unitary Air-Conditioner

R410A 1φ 208-230V / 60Hz

Testing Condition : ASHRAE/T  
CHEER

Model	Disp.		Capacitor		Cooling Capacity		Input Power		EER	COP	Outline Drawing	Safety Approval					
	c.c.	μ F	VAC	Btu/h	W	W	Btu/h.W	W/W	C-UL	VPC		TUV	CCC	VDE	Others		
50N282X	11.4	30	370	11350	3325	1145	9.91	2.90	50-04(b)	☉							
				13650	3995	825	16.55	4.84									
50N382X	14.9	35	370	15275	4475	1480	10.32	3.02	50-04(b)	☉							
				18590	5445	1080	17.21	5.04									
50N382Z	14.9	35	370	15235	4460	1460	10.43	3.05	50-12								
				18570	5440	1040	17.86	5.23									
50N492X	19.2	40	370	19640	5750	1890	10.39	3.04	50-04((b)								
				24285	7110	1385	17.53	5.13									
50N492Z	19.2	45	370	19325	5660	1900	10.17	2.98	50-04(b)	☉							
				24005	7030	1325	18.12	5.31									
50N4929	19.2	45	370	19245	5635	1870	10.29	3.01	50-12								
				23810	6970	1300	18.32	5.36									
50N512X	19.7	40	370	20040	5870	1980	10.12	2.96	50-04((b)								
				24920	7295	1430	17.43	5.10									
50N6229	24.2	50	370	24325	7125	2410	10.09	2.96	50-12								
				30555	8945	1680	18.19	5.32									

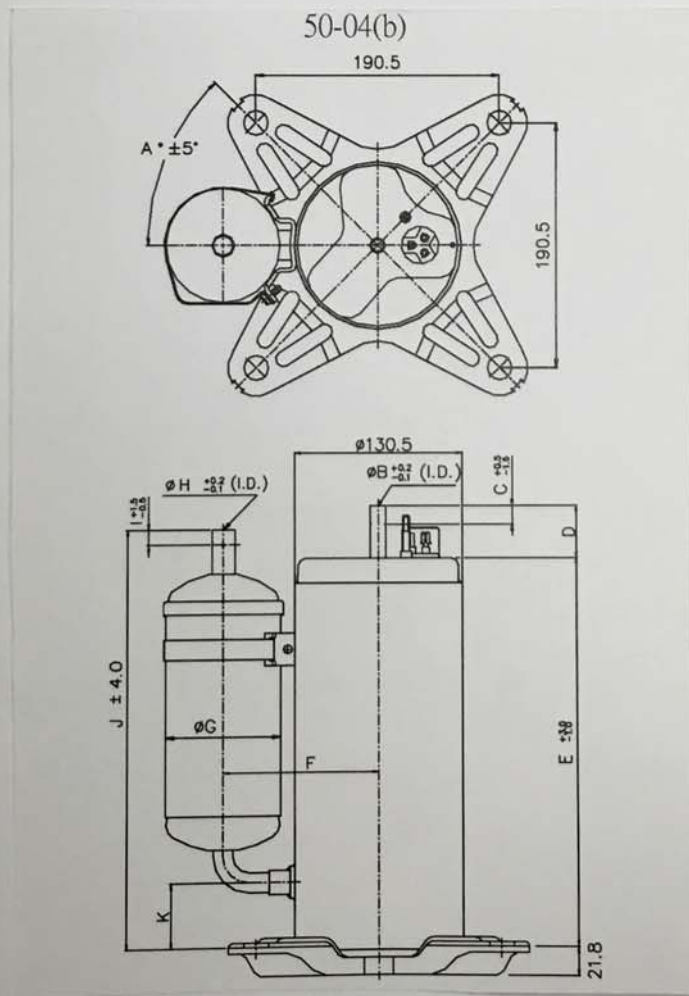



当责 诚信 创新  
Accountability  
Integrity  
Innovation

## 企业简介



瑞智创始於1989年，创始之际即以「技术独立自主、创建一流品牌、打造科技人生」做为公司创业的初衷与理想，全体员工均秉持著「以优异的品质，迈向市场竞争；以卓越的技术，永远领先业界；以完善的服务，赢得客户满意」的经营理念，积极地发展公司的核心技术，致力成为全球顶尖之压缩机供应商。

发展至今，瑞智拥有台湾桃园、广东虎门、广东惠州、山东青岛等生产基地。目前压缩机年产量能达1100万台，马达年产能达1300万套。压缩机产品包含39、44、48、50及55共五大系列，并有单双转子直流变频，绿色环保冷媒等多个机型。广泛应用于空调、除湿机、热泵干衣机、热泵热水器等领域，产品销往全球各地。

Established in 1989, Rechi aims to be the world's leading supplier of compressors with its state-of-the-art technology. All the employees of Rechi believe in improving products and service in order to build long term relationship with clients. Customer satisfaction is of utmost importance to the company and Rechi accomplishes this by consistently looking at the market trends and improving on its technology.

Today, Rechi owns numerous production factories and there are Taiwan, Taoyuan; Guangdong, Humen; Huizhou; and Qingdao Plant. Rechi is capable of producing up to 11 million units of compressors and 13 million sets of motors annually. Compressor products include 39, 44, 48, 50 and 55 frame series and some of these series possesses both single and twin cylinder, DC inverters, environmentally friendly refrigerant and many other models. These products are sold worldwide and are widely used in air conditioners, dehumidifiers, heat-pump dryers, heat-pump water heaters and other products.

## 经营理念

以优异的品质，迈向市场竞争  
以卓越的技术，永远领先业界  
以完善的服务，赢得客户满意

## Philosophy

Quality to market competition  
Technology to lead the trade  
Service to customer satisfaction

## 工厂分布/Factory Location

惠州/Huizhou



Area: 160,000m<sup>2</sup>

青岛/Qingdao



Area: 191,452m<sup>2</sup>

东莞/Dongguan



Area: 34,193.5m<sup>2</sup>

台湾/Taiwan



Area: 29,652m<sup>2</sup>



## 销售网络/Sales Network





身为一个全球主要空调用压缩机之供货商，我们了解也深知我们的产品、服务及活动可能影响到整个生活的环境，我们有责任为全球环境保护尽一份心力，因此，我们将恪守我们的环境政策。

As a major global air-conditioning compressor supplier, we know our products and services and activities may affect the whole life of the environment, we have the responsibility to the global environmental protection, therefore, we will abide by our environmental policy.



## 目录 CONTENTS

<b>压缩机/Compressor</b>	07
压缩机编码原则 Compressor Code Identification	07
压缩机能力分布图 Compressor Cooling Capacity Range	08
压缩机产品规格索引 Product Spec Index	10
变频压缩机 DC Inverter Compressor	11
定速压缩机 Constant-Speed Compressor	13
工作/测试工况 Working / Testing Condition	26
接线图 Wiring Diagram	26
外观图 Outline Drawing	27
外观图尺寸 Dimensions Table for Outline Drawing	29
<b>马达/Motor</b>	31
<b>变频控制器/ Inverter Controller</b>	33



## 压缩机编码原则/Compressor Code Identification

机体系列/Frame Series				电源/Power Source			适用系统/For System	
代码 Code	机壳外径 Comp. O.D.	汽缸数目大小 No., Size of Cyl.	汽缸大小 Size	代码 Code	电压 Voltage	频率 Hz	代码 Code	组合 Combination
39	Φ106	1	-	1	115	60	A-F	一般冷媒量+外置式保护器, 马达组合 General Refrigerant + Ext. OLP, Motor Set.
43		1	较小Smaller	2	208-230	60	G-M	一般冷媒量+内置式保护器, 马达组合 General Refrigerant + Int. OLP, Motor Set.
44	Φ117	1	标准Standard	3	220-240	50	N-T	多冷媒量+外置式保护器, 马达组合 More Refrigerant + Ext. OLP, Motor Set.
45		2	较小Smaller	4	200-220 低电压 Low Voltage	50	U-Z	多冷媒量+内置式保护器, 马达组合 More Refrigerant + Int. OLP, Motor Set.
48	Φ127	1	-	5	100/100-110	50/60		
50	Φ131	1	-	6	115-127	60		
55	Φ147	1	-	7	265	60		
				8	200/200-220	50/60		

代码 Code	组合 Combination
A-F	DC集中绕+铁氧磁石 DC Concentrated Winding + Ferrite Magnet
G-M	DC集中绕+稀土磁石 DC Concentrated Winding + Rare-Earth Magnet
U-Z	DC分布绕+稀土磁石 DC Distributed Winding + Rare-Earth Magnet

代码 Code	组合 Combination
A-F	储液瓶 Accumulator
G-M	泵型式 Pump Type
U-Z	底座角度 Base Plate Angle

代码 Code	组合 Combination
A-F	顶盖 Top Cap
G-M	机油种类 Oil Type
U-Z	机油量 Oil Volume

冷房能力 Cooling Capacity  
Number \*100 Kcal/hr @ASHRAE/T

例. Ex. **39** **A** **12** **1** **A** **A** **&** **1** **4** **K** **A**

冷媒与工作工况/Refrigerant and working condition			
代码 Code	冷媒 Refrigerant	工作工况 Working Condition	典型应用 Typical Application
A	R410A	ASHRAE/T	一般空调机 / 除湿机 General Air-Conditioner / Dehumidifier
B		MAT	北美/中国高效空调机 US/China Hi-EER Air-Conditioner
N		CHEER	北美单元式(有风管的分离式)空调机 US Unitary (Ducted Split) Air-Conditioner
C	R407C	ASHRAE/T	一般空调机/部份用于热泵干衣机 General Air-Conditioner / Some for Heat-Pump Dryer
E	R134a	ASHRAE/T	一般空调机 / 除湿机 General Air-Conditioner / Dehumidifier
F		HPD	热泵干衣机 Heat-Pump Dryer
G		HPWH	热泵热水器 Heat-Pump Water-Heater
R	R22	ASHRAE/T	一般空调机 / 除湿机 General Air-Conditioner / Dehumidifier
S		MAT	中国高效空调机 China Hi-EER Air-Conditioner
T		ASHRAE/T + T3	热带(T3)空调机 Tropical(T3) Air-Conditioner

## 压缩机能力分布图/Compressor Cooling Capacity Range

### 直流变频压缩机 / DC Inverter Compressor

Testing Condition: ASHRAE/T

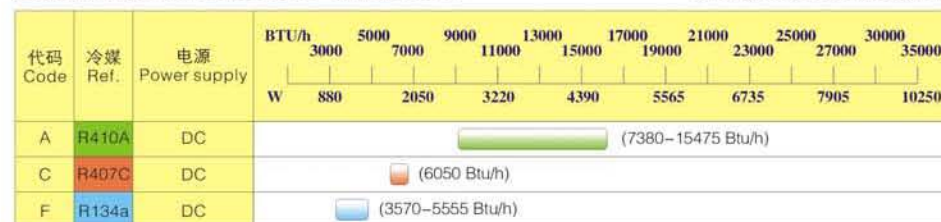

### 定速压缩机 / Constant-Speed Compressor

Testing Condition: ASHRAE/T





## 压缩机能力分布图/Compressor Cooling Capacity Range

定速压缩机 / Constant-Speed Compressor

Testing Condition: ASHRAE/T



## 全球认证布局 / Certification Map



## 压缩机产品规格索引/Product Spec Index

机型 Type	代码 Code	冷媒 Ref.	典型应用 Typical Application	页数 Page
变频压缩机 DC Inverter Compressor	A	R410A	一般空调机 / 除湿机 General Air-Conditioner / Dehumidifier	Page 11
	C	R407C	一般空调机/部份用于热泵干衣机 General Air-Conditioner / Some for Heat-Pump Dryer	Page 12
	F	R134a	热泵干衣机 Heat-Pump Dryer	Page 12
定速压缩机 Constant-Speed Compressor	A	R410A	一般空调机 / 除湿机 General Air-Conditioner / Dehumidifier	Page 13
	B		北美/中国高效空调机 US/China Hi-EER Air-Conditioner	Page 15
	N		北美单元式(有风管的分离式)空调机 US Unitary (Ducted Split) Air-Conditioner	Page 16
	C	R407C	一般空调机/部份用于热泵干衣机 General Air-Conditioner / Some for Heat-Pump Dryer	Page 17
	E	R134a	一般空调机 / 除湿机 General Air-Conditioner / Dehumidifier	Page 18
	F		热泵干衣机 Heat-Pump Dryer	Page 19
	G		热泵热水器 Heat-Pump Water-Heater	Page 19
	R	R22	一般空调机 / 除湿机 General Air-Conditioner / Dehumidifier	Page 20
	S		中国高效空调机 China Hi-EER Air-Conditioner	Page 24
	T		热带(T3)空调机 Tropical(T3) Air-Conditioner	Page 25



**A** 典型应用：一般空调机 / 除湿机  
 Typical Application: General Air-Conditioner / Dehumidifier

**R410A 单缸直流变频 DC Inverter Single Cylinder**

Testing Condition : ASHRAE/T

Model	Disp. c.c.	Capacitor		Cooling Capacity		Input Power W	EER	COP	Outline Drawing	Safety Recognition					
		μF	VAC	Btu/h	W					C-UL	VPC	TUV	CCC	VDE	Others
39A18VB (Δ)	7.25	*	*	7380	2160	715	10.32	3.02	39-10						
39A18XP (Δ)	7.25	*	*	7380	2160	720	10.25	3.00	39-10						
39A18YA (Δ)	7.25	*	*	7380	2160	740	9.97	2.92	39-10						
39A18YP (Δ)	7.25	*	*	7460	2185	715	10.43	3.06	39-10		○		○		
39A23VP (Δ)	9.0	*	*	9365	2740	910	10.29	3.01	39-10		○	○	○		
39A23VS (Δ)	9.0	*	*	9305	2725	905	10.28	3.01	39-10		○		○		
39A23WP (Δ)	9.0	*	*	9365	2740	915	10.23	2.99	39-10						
39A23XP (Δ)	9.0	*	*	9365	2740	905	10.35	3.03	39-10				○		
39A23YA (Δ)	9.0	*	*	9365	2740	935	10.02	2.93	39-06						
39A23YP (Δ)	9.0	*	*	9365	2740	900	10.41	3.04	39-10				○		
39A26VP (Δ)	10.4	*	*	10870	3185	1045	10.40	3.05	39-10						
39A26XP (Δ)	10.4	*	*	10870	3185	1050	10.35	3.03	39-10		○		○		
39A26XP (Δ)	11.4	*	*	11905	3485	1160	10.26	3.00	39-10						
43A23VB (Δ)	9.0	*	*	9365	2740	905	10.35	3.03	44-02					○	
43A23YB (Δ)	9.0	*	*	9365	2740	890	10.52	3.08	44-02		○		○		
43A26XN (Δ)	10.4	*	*	10870	3185	1050	10.35	3.03	44-02						
44A23WB (Δ)	9.2	*	*	9445	2765	940	10.05	2.94	44-02						
44A28WB (Δ)	11.4	*	*	11705	3430	1170	10.00	2.93	44-02			○			
44A28WP (Δ)	11.4	*	*	11945	3500	1185	10.08	2.95	44-02						
44A33WN (Δ)	13.2	*	*	13770	4030	1390	9.91	2.90	44-06						
44A33XN (Δ)	13.2	*	*	14165	4150	1385	10.23	3.00	44-06		○	○			
44A37WN (Δ)	14.7	*	*	15475	4530	1530	10.11	2.96	44-06		○				
43A23DE (▲)	9.0	*	*	9305	2725	910	10.23	2.99	44-07				○		
43A23DP (▲)	9.0	*	*	9305	2725	910	10.23	2.99	44-09				○		
43A23DS (▲)	9.0	*	*	9305	2725	910	10.23	2.99	44-10		○				
43A23EE (▲)	9.0	*	*	9305	2725	905	10.28	3.01	44-07						
43A26CE (▲)	10.4	*	*	10870	3185	1070	10.16	2.98	44-02						
43A26CS (▲)	10.4	*	*	10870	3185	1070	10.16	2.98	44-06						

(Δ) 机型为稀土磁石 Rare Earth Magnet  
 (▲) 机型为铁氧磁石 Ferrite Magnet

**R410A 双缸直流变频 DC Inverter Twin Cylinder**

Testing Condition : ASHRAE/T

Model	Disp. c.c.	Capacitor		Cooling Capacity		Input Power W	EER	COP	Outline Drawing	Safety Recognition					
		μF	VAC	Btu/h	W					C-UL	VPC	TUV	CCC	VDE	Others
45A33LN (Δ)	13.2	*	*	13690	4010	1300	10.53	3.08	44-02						

(Δ) 机型为稀土磁石 Rare Earth Magnet

**C** 典型应用：一般空调机/部份用于热泵干衣机  
 Typical Application: General Air-Conditioner / Some for Heat-Pump Dryer

**R407C 单缸直流变频 DC Inverter Single Cylinder**

Testing Condition : ASHRAE/T  
HPD

Model	Disp. c.c.	Capacitor		Cooling Capacity		Input Power W	EER	COP	Outline Drawing	Safety Recognition					
		μF	VAC	Btu/h	W					C-UL	VPC	TUV	CCC	VDE	Others
39C14WA (Δ)	8.1	*	*	6050	1770	565	10.71	3.13	39-26						
				8810	2580	815	10.81	3.17							

(Δ) 机型为稀土磁石 Rare Earth Magnet

**F** 典型应用：一般空调机 / 除湿机  
 Typical Application: General Air-Conditioner / Dehumidifier

**R134a 单缸直流变频 DC Inverter Single Cylinder**

Testing Condition : ASHRAE/T  
HPD

Model	Disp. c.c.	Capacitor		Cooling Capacity		Input Power W	EER	COP	Outline Drawing	Safety Recognition					
		μF	VAC	Btu/h	W					C-UL	VPC	TUV	CCC	VDE	Others
39FQJWA (Δ)	7.25	*	*	3570	1045	320	11.16	3.27	39-26						
				5395	1580	445	12.12	3.55							
39F1AWA (Δ)	9.0	*	*	4365	1280	400	10.91	3.20	39-26						
				6805	1995	570	11.94	3.50							
39F1AXA (Δ)	9.0	*	*	4365	1280	395	11.05	3.24	39-26						
				6805	1995	565	12.04	3.53							
39F1AYA (Δ)	9.0	*	*	4365	1280	390	11.19	3.28	39-26						
				6805	1995	560	12.15	3.56							
39F13WA (Δ)	11.4	*	*	5555	1625	505	11.00	3.22	39-03						
				8650	2535	730	11.85	3.47							

(Δ) 机型为稀土磁石 Rare Earth Magnet



**A** 典型应用: 一般空调机 / 除湿机  
Typical Application: General Air-Conditioner / Dehumidifier

**R410A 1Φ 115V / 60Hz**

Testing Condition : ASHRAE/T

Model	Disp. c.c.	Capacitor		Cooling Capacity		Input Power W	EER	COP	Outline Drawing	Safety Recognition							
		μF	VAC	Btu/h	W					Btu/h.W	W/W	C-UL	VPC	TUV	CCC	VDE	Others
39A081F	3.5	15	270	3255	955	405	8.04	2.36	39-07	○							
39A1A1F	4.5	15	270	4225	1240	520	8.13	2.38	39-07	○							
39A111A	4.75	35	250	4660	1365	485	9.61	2.81	39-09	○							
39A121A	5.0	35	250	4840	1420	505	9.58	2.81	39-09	○							
39A131A	5.25	35	250	4960	1455	540	9.19	2.69	39-06	○							CB
39A131F	5.25	15	300	4960	1455	600	8.27	2.43	39-07	○							
39A1D1F	5.5	20	300	5200	1520	655	7.94	2.32	39-07	○							
39A141A	5.75	35	250	5475	1605	560	9.78	2.87	39-09	○							
39A151A	6.25	35	250	6030	1765	620	9.73	2.85	39-09	○	○						
39A171A	7.0	35	250	6845	2005	710	9.64	2.82	39-06	○							
39A181A	7.25	35	250	7085	2075	725	9.77	2.86	39-06	○							
39A191A	7.75	40	250	7620	2230	800	9.53	2.79	39-06	○							
39A201A	8.1	40	250	7935	2325	845	9.39	2.75	39-06	○							
39A221A	9.0	40	250	8890	2605	940	9.46	2.77	39-06	○							
44A201A	8.1	60	250	8035	2355	800	10.04	2.94	44-07	○							
44A211A	8.35	60	250	8315	2435	830	10.02	2.93	44-07	○							
44A221A	8.9	60	250	8890	2605	885	10.05	2.94	44-07	○							Inmetro
44A231A	9.2	60	250	8930	2615	950	9.40	2.75	44-07	○							CB
44A231B	9.2	60	250	9205	2695	920	10.01	2.93	44-07	○							
44A261A	10.3	60	250	10375	3040	1025	10.12	2.97	44-07	○							
44A271A	10.8	60	250	10715	3135	1075	9.97	2.92	44-07	○							
44A281A	11.4	60	250	10910	3195	1175	9.29	2.72	44-02	○							CB
44A281B	11.4	60	250	11230	3290	1125	9.98	2.92	44-07	○							
44A301A	11.9	60	250	11805	3455	1190	9.92	2.90	44-07	○							
44A321A	12.8	60	250	13055	3825	1290	10.12	2.97	44-02	○							
44A341A	13.5	60	250	13630	3990	1375	9.91	2.90	44-02	○							

**R410A 1Φ 208-230V / 60Hz**

Testing Condition : ASHRAE/T

Model	Disp. c.c.	Capacitor		Cooling Capacity		Input Power W	EER	COP	Outline Drawing	Safety Recognition							
		μF	VAC	Btu/h	W					Btu/h.W	W/W	C-UL	VPC	TUV	CCC	VDE	Others
39A142A	5.75	15	400	5555	1625	575	9.66	2.83	39-09	○							
39A142I	5.75	15	400	5555	1625	575	9.66	2.83	39-09	○							
39A162A	6.75	20	370	6490	1900	655	9.91	2.90	39-06	○	○						
39A172A	7.0	20	370	6825	2000	695	9.82	2.88	39-06	○							
44A202A	8.1	25	370	7895	2310	785	10.06	2.94	44-07	○	○						CB
44A202I	8.1	25	370	7895	2310	785	10.06	2.94	44-07	○							
44A212A	8.35	25	370	8315	2435	820	10.14	2.97	44-07	○	○						Inmetro
44A222A	8.9	30	370	8830	2585	860	10.27	3.01	44-07	○	○						CB

**R410A 1Φ 208-230V / 60Hz**

Testing Condition : ASHRAE/T

Model	Disp. c.c.	Capacitor		Cooling Capacity		Input Power W	EER	COP	Outline Drawing	Safety Recognition							
		μF	VAC	Btu/h	W					Btu/h.W	W/W	C-UL	VPC	TUV	CCC	VDE	Others
44A232A	9.2	30	370	9025	2645	900	10.03	2.94	44-07								
44A262A	10.3	30	370	10000	2930	1010	9.90	2.90	44-02	○							
44A262B	10.3	30	370	10275	3010	1005	10.22	3.00	44-07	○	○						Inmetro
44A272A	10.8	30	370	10850	3180	1060	10.24	3.00	44-07	○	○						Inmetro
44A282A	11.4	30	370	11230	3290	1125	9.98	2.92	44-07	○	○						CB
44A282N	11.4	30	370	11390	3335	1140	9.99	2.93	44-06		○						
44A282I	11.4	30	370	11230	3290	1125	9.98	2.92	44-07								
44A302A	11.9	30	370	11965	3505	1170	10.23	3.00	44-07	○	○						
44A302N	11.9	30	370	11965	3505	1200	9.97	2.92	44-06		○						
44A322A	12.8	35	370	12795	3745	1260	10.15	2.97	44-02	○	○						CB
44A342A	13.5	30	370	13570	3975	1360	9.98	2.92	44-02	○	○						
50A362Q	14.4	30	370	14505	4245	1410	10.29	3.01	50-03	○	○						
50A382Q	14.9	35	370	15275	4475	1480	10.32	3.02	50-03		○						
50A422Q	16.6	40	370	16945	4960	1650	10.27	3.01	50-03		○						
50A452P	17.7	40	370	17995	5270	1805	9.97	2.92	50-03	○	○						CB
50A492P	19.2	45	370	19525	5715	1970	9.91	2.90	50-03		○						
50A522V	20.2	50	370	20675	6055	2030	10.18	2.98	50-03		○						
50A562V	22.2	50	370	22735	6660	2250	10.10	2.96	50-03		○						
50A612V	23.5	45	400	23810	6970	2450	9.72	2.84	50-03	○	○						

**R410A 1Φ 220-240V / 50Hz**

Testing Condition : ASHRAE/T

Model	Disp. c.c.	Capacitor		Cooling Capacity		Input Power W	EER	COP	Outline Drawing	Safety Recognition							
		μF	VAC	Btu/h	W					Btu/h.W	W/W	C-UL	VPC	TUV	CCC	VDE	Others
39A143A	7.5	20	370	5755	1685	630	9.13	2.67	39-06			○	○				
39A173A	8.6	25	370	6825	2000	750	9.10	2.67	39-06			○	○				CE
44A203A	10.3	40	370	8055	2360	850	9.48	2.78	44-02			○	○				CB
44A203B	10.3	40	370	8370	2450	860	9.73	2.85	44-07			○	○				
44A233A	11.4	40	370	9005	2640	930	9.68	2.84	44-02			○	○				CB,CE
44A263A	13.2	35	370	10275	3010	1090	9.43	2.76	44-02			○					CB
44A263B	13.2	35	370	10795	3160	1115	9.68	2.83	44-02			○	○				
44A273A	13.5	30	370	10990	3220	1150	9.56	2.80	44-02			○					CB
44A273B	13.5	35	370	10930	3200	1120	9.76	2.86	44-02			○	○				
44A293A	14.4	30	370	11430	3345	1220	9.37	2.74	44-02			○	○				CB
44A313A	15.6	35	370	12775	3740	1325	9.64	2.82	44-02			○	○				CB
48A313A	14.9	30	370	12065	3530	1290	9.35	2.74	48-02			○					
48A313N	14.9	30	370	12140	3555	1290	9.41	2.76	48-03								
48A313P	14.9	30	370	12100	3545	1245	9.72	2.85	48-03			○	○				CE
48A343A	16.0	30	370	13135	3845	1390	9.45	2.77	48-02			○					
48A413A	20.2	30	370	16270	4765	1770	9.19	2.69	48-02			○					
48A473U	23.5	35	370	19045	5580	2050	9.29	2.72	48-03			○					



**R410A 1Φ 220-240V / 50Hz**

Testing Condition : ASHRAE/T

Model	Disp. c.c.	Capacitor μF VAC	Cooling Capacity		Input Power W	EER Btu/h.W	COP W/W	Outline Drawing	Safety Recognition						
			Btu/h	W					C-UL	VPC	TUV	CCC	VDE	Others	
50A403V	19.2	35 400	15950	4670	1600	9.97	2.92	50-03							
50A433V	20.8	35 370	17180	5030	1740	9.87	2.89	50-03							
50A453V	21.4	35 370	17895	5240	1810	9.89	2.90	50-03			○				
50A473V	22.2	45 400	18690	5475	1890	9.89	2.90	50-03			○				

**R410A 1Φ 100/100-110V 50/60Hz**

Testing Condition : ASHRAE/T

Model	Disp. c.c.	Capacitor μF VAC	Cooling Capacity		Input Power W	EER Btu/h.W	COP W/W	Outline Drawing	Safety Recognition						
			Btu/h	W					C-UL	VPC	TUV	CCC	VDE	Others	
39A155A	50Hz	6.25 60 250	4960	1455	565	8.78	2.58	39-06							
	60Hz		6030	1765	650	9.28	2.72								
39A175A	50Hz	7.0 60 250	5555	1625	630	8.82	2.58	39-06							
	60Hz		6745	1975	730	9.24	2.71								

**R410A 1Φ 115-127V / 60Hz**

Testing Condition : ASHRAE/T

Model	Disp. c.c.	Capacitor μF VAC	Cooling Capacity		Input Power W	EER Btu/h.W	COP W/W	Outline Drawing	Safety Recognition						
			Btu/h	W					C-UL	VPC	TUV	CCC	VDE	Others	
44A226A	8.9	60 250	9005	2640	905	9.95	2.92	44-07							Inmetro

**R410A 1Φ 265V / 60Hz**

Testing Condition : ASHRAE/T

Model	Disp. c.c.	Capacitor μF VAC	Cooling Capacity		Input Power W	EER Btu/h.W	COP W/W	Outline Drawing	Safety Recognition						
			Btu/h	W					C-UL	VPC	TUV	CCC	VDE	Others	
39A147A	5.75	15 400	5555	1625	575	9.66	2.83	39-09	○						
39A167A	6.75	15 370	6545	1915	655	9.99	2.92	39-06	○						
44A207A	8.1	25 370	7915	2320	790	10.02	2.94	44-07	○						
44A267A	10.3	30 370	10395	3045	1025	10.14	2.97	44-07	○						
44A287A	11.4	30 370	11290	3305	1120	10.08	2.95	44-07	○						
50A367Q	14.4	25 420	14245	4170	1405	10.14	2.97	50-03	○						

**B** 典型应用: 北美/中国高效空调机  
Typical Application: US/China Hi-EER Air-Conditioner

**R410A 1Φ 115V / 60Hz**

Testing Condition : ASHRAE/T  
MAT

Model	Disp. c.c.	Capacitor μF VAC	Cooling Capacity		Input Power W	EER Btu/h.W	COP W/W	Outline Drawing	Safety Recognition						
			Btu/h	W					C-UL	VPC	TUV	CCC	VDE	Others	
39B071A	3.25	15 270	3015	885	375	8.04	2.36	39-07							
			3890	1140	315	12.35	3.62								
39B111A	4.75	35 250	4585	1340	475	9.65	2.82	39-09							
			5890	1725	385	15.30	4.48								
39B131A	5.52	35 250	4980	1460	520	9.58	2.81	39-09							
			6565	1925	430	15.27	4.48								

**R410A 1Φ 115V / 60Hz**

Testing Condition : ASHRAE/T  
MAT

Model	Disp. c.c.	Capacitor μF VAC	Cooling Capacity		Input Power W	EER Btu/h.W	COP W/W	Outline Drawing	Safety Recognition						
			Btu/h	W					C-UL	VPC	TUV	CCC	VDE	Others	
39B161A	6.75	35 250	6545	1915	680	9.63	2.82	39-06							
			8510	2490	560	15.20	4.45								
39B171A	7.0	35 250	6765	1980	705	9.60	2.81	39-26							
			8790	2575	575	15.29	4.48								
44B2B1A	8.6	55 250	8550	2505	855	10.00	2.93	44-07							
			10870	3185	695	15.64	4.58								
44B261A	10.3	55 250	10255	3005	1030	9.96	2.92	44-07	○						
			13115	3840	835	15.71	4.60								
44B311A	12.4	60 250	12005	3515	1225	9.80	2.87	44-02	○						
			15795	4625	1015	15.56	4.56								

**R410A 1Φ 208-230V / 60Hz**

Testing Condition : ASHRAE/T  
MAT

Model	Disp. c.c.	Capacitor μF VAC	Cooling Capacity		Input Power W	EER Btu/h.W	COP W/W	Outline Drawing	Safety Recognition						
			Btu/h	W					C-UL	VPC	TUV	CCC	VDE	Others	
39B212A	8.35	25 370	8055	2360	840	9.59	2.81	39-06			○				
			10435	3055	695	15.01	4.40								
50B562X	22.2	50 370	22695	6645	2245	10.11	2.96	50-04			○				
			29085	8515	1925	15.11	4.42								

**R410A 1Φ 220-240V / 50Hz**

Testing Condition : ASHRAE/T  
MAT

Model	Disp. c.c.	Capacitor μF VAC	Cooling Capacity		Input Power W	EER Btu/h.W	COP W/W	Outline Drawing	Safety Recognition						
			Btu/h	W					C-UL	VPC	TUV	CCC	VDE	Others	
50B403W	19.2	35 400	16110	4720	1610	10.01	2.93	50-03							
			20675	6055	1310	15.78	4.62								

**R410A 1Φ 265V / 60Hz**

Testing Condition : ASHRAE/T  
MAT

Model	Disp. c.c.	Capacitor μF VAC	Cooling Capacity		Input Power W	EER Btu/h.W	COP W/W	Outline Drawing	Safety Recognition						
			Btu/h	W					C-UL	VPC	TUV	CCC	VDE	Others	
44B207A	8.1	20 370	7835	2295	785	9.98	2.92	44-07	○						
			10020	2935	645	15.53	4.55								
44B267A	10.3	25 370	10160	2975	1015	10.01	2.93	44-07	○						
			13095	3835	850	15.41	4.51								

**N** 典型应用: 北美单元式空调机  
Typical Application: US Unitary Air-Conditioner

**R410A 1Φ 208-230V / 60Hz**

Testing Condition : ASHRAE/T  
MAT

Model	Disp. c.c.	Capacitor μF VAC	Cooling Capacity		Input Power W	EER Btu/h.W	COP W/W	Outline Drawing	Safety Recognition						
			Btu/h	W					C-UL	VPC	TUV	CCC	VDE	Others	
50N382X	14.9	35 370	15275	4475	1480	10.32	3.02	50-04(b)	○						
			18590	5445	1080	17.21	5.04								
50N492X	19.2	40 370	19640	5750	1890	10.39	3.04	50-04((b))							
			24285	7110	1385	17.53	5.13								
50N512X	19.7	40 370	20040	5870	1980	10.12	2.96	50-04((b))							
			24920	7295	1430	17.43	5.10								

# 定速压缩机/Constant-Speed Compressor



# 定速压缩机/Constant-Speed Compressor



典型应用: 一般空调机/部份用于热泵干衣机  
Typical Application: General Air-Conditioner / Some for Heat-Pump Dryer

## R407C 1Φ 115V / 60Hz

Testing Condition : ASHRAE/T

Model	Disp. c.c.	Capacitor μF VAC	Cooling Capacity		Input Power W	EER Btu/h.W	COP W/W	Outline Drawing	Safety Recognition						
			Btu/h	W					C-UL	VPC	TUV	CCC	VDE	Others	
39C121B	7.0	15 270	4920	1440	580	8.48	2.48	39-07							

## R407C 1Φ 208-230V / 60Hz

Testing Condition : ASHRAE/T

Model	Disp. c.c.	Capacitor μF VAC	Cooling Capacity		Input Power W	EER Btu/h.W	COP W/W	Outline Drawing	Safety Recognition						
			Btu/h	W					C-UL	VPC	TUV	CCC	VDE	Others	
39C172B	10.4	20 370	7300	2140	720	10.14	2.97	39-01							

## R407C 1Φ 220-240V / 50Hz

Testing Condition : ASHRAE/T  
HPD

Model	Disp. c.c.	Capacitor μF VAC	Cooling Capacity		Input Power W	EER Btu/h.W	COP W/W	Outline Drawing	Safety Recognition						
			Btu/h	W					C-UL	VPC	TUV	CCC	VDE	Others	
39C123B	8.1	20 370	4605 6645	1350 1945	460 655	10.01 10.15	2.93 2.97	39-01			○	○	○	○	CE
39C123D	8.1	20 370	4820 6785	1410 1985	490 690	9.84 9.83	2.88 2.88	39-08							
39C123H	8.1	20 370	4605 6645	1350 1945	460 655	10.01 10.15	2.93 2.97	39-01							
39C143C	10.4	20 370	6070 8770	1780 2570	610 890	9.95 9.85	2.92 2.89	39-01			○			○	CE
39C163B	11.1	20 370	6430	1880	650	9.89	2.89	39-01			○				
44C173A	12.4	40 370	7180	2105	695	10.33	3.03	44-02			○				
44C193A	13.2	40 370	7540	2210	720	10.47	3.07	44-02			○				
44C203A	14.7	40 370	8450	2475	815	10.37	3.04	44-02			○				
44C213A	15.6	40 370	9005	2640	865	10.41	3.05	44-02			○				
44C233A	16.4	40 370	9365	2740	905	10.35	3.03	44-02			○	○			
44C233B	16.4	25 370	9365	2740	940	9.96	2.91	44-02			○				
44C243B	16.8	25 370	9640	2825	965	9.99	2.93	44-02			○				
44C253A	18.1	35 370	10475	3070	1020	10.27	3.01	44-02			○				
44C273A	19.1	35 370	11070	3240	1090	10.16	2.97	44-02			○				
48C313A	21.4	30 370	12915	3780	1280	10.09	2.95	48-02			○				
48C313N	21.4	30 370	12915	3780	1280	10.09	2.95	48-03							
48C323A	22.2	25 370	13295	3895	1310	10.15	2.97	48-02			○				
48C323N	22.2	30 370	13410	3930	1310	10.24	3.00	48-03			○				
48C343A	23.5	30 370	14125	4135	1380	10.24	3.00	48-02			○				
48C343N	23.5	30 370	14125	4135	1380	10.24	3.00	48-03							
48C373A	25.8	30 370	15595	4565	1580	9.87	2.89	48-02			○				
48C403A	27.1	30 370	16505	4835	1670	9.88	2.90	48-02			○				
48C413A	28.0	30 370	16745	4905	1690	9.91	2.90	48-02			○	○			
48C453A	30.6	35 370	18290	5355	1860	9.83	2.88	48-07				○			
48C473A	32.5	35 370	19245	5635	1970	9.77	2.86	48-07			○	○			
48C473U	32.5	35 370	19245	5635	1950	9.87	2.89	48-08							

## R407C 1Φ 100/100-110V 50/60Hz

Testing Condition : ASHRAE/T

Model	Disp. c.c.	Capacitor μF VAC	Cooling Capacity		Input Power W	EER Btu/h.W	COP W/W	Outline Drawing	Safety Recognition						
			Btu/h	W					C-UL	VPC	TUV	CCC	VDE	Others	
39C085A	4.75	25 250	2740	800	300	9.13	2.67	39-06							
			3295	965	340	9.69	2.84								
39C125A	7.0	25 250	4010	1175	415	9.66	2.83	39-06							
			4800	1405	495	9.70	2.84								

## R407C 1Φ 200/200-220V 50/60Hz

Testing Condition : ASHRAE/T

Model	Disp. c.c.	Capacitor μF VAC	Cooling Capacity		Input Power W	EER Btu/h.W	COP W/W	Outline Drawing	Safety Recognition						
			Btu/h	W					C-UL	VPC	TUV	CCC	VDE	Others	
39C088A	4.75	15 370	2780	815	300	9.27	2.72	39-06							
			3335	975	350	9.53	2.79								
39C128A	7.0	15 370	4010	1175	400	10.03	2.94	39-06							
			4840	1420	480	10.08	2.96								
39C178B	10.4	25 370	6010	1760	615	9.77	2.86	39-01							
			7200	2110	710	10.14	2.97								
48C428A	23.5	50 370	14145	4145	1380	10.25	3.00	48-02							
			16805	4920	1640	10.25	3.00								



典型应用: 一般空调机 / 除湿机  
Typical Application: General Air-Conditioner / Dehumidifier

## R134a 1Φ 115V / 60Hz

Testing Condition : ASHRAE/T

Model	Disp. c.c.	Capacitor μF VAC	Cooling Capacity		Input Power W	EER Btu/h.W	COP W/W	Outline Drawing	Safety Recognition						
			Btu/h	W					C-UL	VPC	TUV	CCC	VDE	Others	
39E081A	7.0	15 270	3255	955	370	8.80	2.58	39-07	○						
39E091B	7.5	15 270	3490	1025	380	9.18	2.70	39-07	○						
39E101A	8.6	15 300	4125	1210	470	8.78	2.57	39-07	○						
39E111A	9.5	15 300	4525	1325	510	8.87	2.60	39-03	○						
39E121A	10.4	15 300	4960	1455	555	8.94	2.62	39-03	○						
39E131A	11.4	15 300	5395	1580	600	8.99	2.63	39-03	○						
39E131C	11.4	35 250	5375	1575	520	10.34	3.03	39-04							

## R134a 1Φ 208-230V / 60Hz

Testing Condition : ASHRAE/T

Model	Disp. c.c.	Capacitor μF VAC	Cooling Capacity		Input Power W	EER Btu/h.W	COP W/W	Outline Drawing	Safety Recognition						
			Btu/h	W					C-UL	VPC	TUV	CCC	VDE	Others	
39E102A	8.6	10 370	4065	1190	445	9.13	2.67	39-07							

## R134a 1Φ 220-240V / 50Hz

Testing Condition : ASHRAE/T

Model	Disp. c.c.	Capacitor μF VAC	Cooling Capacity		Input Power W	EER Btu/h.W	COP W/W	Outline Drawing	Safety Recognition						
			Btu/h	W					C-UL	VPC	TUV	CCC	VDE	Others	
39E043A	4.75	9 370	1845	540	195	9.46	2.77	39-07							
39E063B	6.5	12 330	2540	745	265	9.58	2.81	39-07			○				
39E073B	7.5	12 330	2875	840	300	9.58	2.80	39-07			○	○	○		
39E103A	10.4	12 420	4045	1185	460	8.79	2.58	39-03			○	○			
39E113A	11.4	12 420	4445	1300	480	9.26	2.71	39-03			○				



**F** 典型应用: 热泵干衣机  
Typical Application: Heat-Pump Dryer

**R134a 1Φ 115V / 60Hz**

Testing Condition : ASHRAE/T HPD

Model	Disp. c.c.	Capacitor μF VAC	Cooling Capacity		Input Power W	EER Btu/h.W	COP W/W	Outline Drawing	Safety Recognition						
			Btu/h	W					W	Btu/h.W	W/W	C-UL	VPC	TUV	CCC
39F131C	11.4	40 250	5455	1600	535	10.20	2.99	39-04							
			8235	2410	765	10.76	3.15								

**R134a 1Φ 208-230V / 60Hz**

Testing Condition : ASHRAE/T HPD

Model	Disp. c.c.	Capacitor μF VAC	Cooling Capacity		Input Power W	EER Btu/h.W	COP W/W	Outline Drawing	Safety Recognition						
			Btu/h	W					W	Btu/h.W	W/W	C-UL	VPC	TUV	CCC
44F172A	14.7	30 370	6965	2040	650	10.72	3.14	44-02							
			10575	3095	890	11.88	3.48								

**R134a 1Φ 220-240V / 50Hz**

Testing Condition : ASHRAE/T HPD

Model	Disp. c.c.	Capacitor μF VAC	Cooling Capacity		Input Power W	EER Btu/h.W	COP W/W	Outline Drawing	Safety Recognition						
			Btu/h	W					W	Btu/h.W	W/W	C-UL	VPC	TUV	CCC
39F0H3C	8.1	18 370	3275	960	345	9.49	2.78	39-08							
			4920	1440	460	10.70	3.13								
39F103B	10.4	20 370	4205	1230	410	10.26	3.00	39-01							
			6270	1835	575	10.90	3.19								
39F103C	10.4	18 370	4225	1240	425	9.94	2.92	39-04							
			6270	1835	590	10.63	3.11								
39F113B	11.4	20 370	4585	1340	445	10.30	3.01	39-01							
			6845	2005	620	11.04	3.23								
39F113C	11.4	18 370	4625	1355	455	10.16	2.98	39-04							
			6865	2010	655	10.48	3.07								CB
39F113H	11.4	20 370	4585	1340	445	10.30	3.01	39-01							
			6845	2005	620	11.04	3.23								
44F193C	19.1	25 370	7700	2255	740	10.41	3.05	44-01							
			11470	3360	1050	10.92	3.20								

**G** 典型应用: 热泵热水器  
Typical Application: Heat-Pump Water-Heater

**R134a 1Φ 208-230V / 60Hz**

Testing Condition : ASHRAE/T HPWH

Model	Disp. c.c.	Capacitor μF VAC	Cooling Capacity		Input Power W	EER Btu/h.W	COP W/W	Outline Drawing	Safety Recognition						
			Btu/h	W					W	Btu/h.W	W/W	C-UL	VPC	TUV	CCC
39G102A	8.6	10 370	4045	1185	375	10.79	3.16	39-06							
			6130	1795	535	11.46	3.36								
44G212A	17.5	30 370	8135	2380	780	10.43	3.05	44-02							
			7460	2185	925	8.06	2.36								

**R134a 1Φ 220-240V / 50Hz**

Testing Condition : ASHRAE/T HPWH

Model	Disp. c.c.	Capacitor μF VAC	Cooling Capacity		Input Power W	EER Btu/h.W	COP W/W	Outline Drawing	Safety Recognition						
			Btu/h	W					W	Btu/h.W	W/W	C-UL	VPC	TUV	CCC
39G113B	11.4	20 370	4585	1340	445	10.30	3.01	39-01							
			4105	1205	520	7.89	2.32								
44G123A	12.4	25 370	4820	1410	450	10.71	3.13	44-02							
			4485	1315	530	8.46	2.48								
44G173A	17.5	35 370	6865	2010	640	10.73	3.14	44-02							
			6440	1885	760	8.47	2.48								
50G243N	23.5	30 370	9485	2775	845	11.22	3.28	50-03							
			8910	2610	1005	8.87	2.60								

**R** 典型应用: 一般空调机 / 除湿机  
Typical Application: General Air-Conditioner / Dehumidifier

**R22 1Φ 115V / 60Hz**

Testing Condition : ASHRAE/T

Model	Disp. c.c.	Capacitor μF VAC	Cooling Capacity		Input Power W	EER Btu/h.W	COP W/W	Outline Drawing	Safety Recognition						
			Btu/h	W					W	Btu/h.W	W/W	C-UL	VPC	TUV	CCC
39R081A	4.75	15 270	3295	965	375	8.79	2.57	39-07							
39R101A	6.25	15 270	4285	1255	505	8.49	2.49	39-07							
39R111A	6.75	15 270	4445	1300	525	8.47	2.48	39-07							
39R121A	7.0	35 250	4820	1410	465	10.37	3.03	39-01							
39R121B	7.0	15 270	4760	1395	560	8.50	2.49	39-07							
39R131E	7.5	35 250	5160	1510	505	10.22	2.99	39-08							
39R131F	7.75	15 270	5240	1535	620	8.45	2.48	39-07							
39R141B	8.6	40 250	6010	1760	565	10.64	3.12	39-01							
39R141C	8.1	40 250	5515	1615	530	10.41	3.05	39-01							
39R151C	9.0	40 250	6190	1815	600	10.32	3.03	39-01							
39R161B	9.75	60 250	6705	1965	665	10.08	2.95	39-01							Inmetro
39R161C	9.5	15 300	6510	1905	725	8.98	2.63	39-02							
39R161D	9.5	15 300	6470	1895	750	8.63	2.53	39-03							
39R161E	9.75	35 250	6825	2000	680	10.04	2.94	39-01							
39R171D	10.4	35 250	7105	2080	700	10.15	2.97	39-01							
39R171E	10.4	15 370	6985	2045	770	9.07	2.66	39-02							
39R191C	11.1	35 250	7580	2220	760	9.97	2.92	39-01							
39R201A	11.4	35 250	7815	2290	765	10.22	2.99	39-01							Inmetro
39R201B	11.4	35 250	7775	2280	755	10.30	3.02	39-01							
44R201A	11.4	60 250	7740	2265	745	10.39	3.04	44-02							
44R211A	12.4	60 250	8410	2465	805	10.45	3.06	44-02							
44R231A	13.2	60 250	8890	2605	850	10.46	3.06	44-02							Inmetro
44R231B	13.5	60 250	9285	2720	880	10.55	3.09	44-02							
44R2D1C	13.5	60 250	9325	2730	880	10.60	3.10	44-07							Inmetro
44R241A	14.4	60 250	9800	2870	950	10.32	3.02	44-02							
44R251A	14.7	60 250	10040	2940	970	10.35	3.03	44-02							Inmetro
44R261A	15.6	60 250	10635	3115	1025	10.38	3.04	44-02							
44R281A	16.4	60 250	11230	3290	1085	10.35	3.03	44-02							
44R291A	16.8	60 250	11545	3380	1110	10.40	3.05	44-02							Inmetro
44R311A	18.1	60 250	12580	3685	1200	10.48	3.07	44-02							Inmetro
44R331A	19.1	60 250	13215	3870	1280	10.32	3.02	44-02							
48R361A	20.2	55 250	14085	4125	1410	9.99	2.93	48-02							

定速压缩机/Constant-Speed Compressor



定速压缩机/Constant-Speed Compressor



R22 1Φ 208-230V / 60Hz

Testing Condition : ASHRAE/T

Model	Disp. c.c.	Capacitor		Cooling Capacity		Input Power W	EER Btu/h.W	COP W/W	Outline Drawing	Safety Recognition					
		μF	VAC	Btu/h	W					C-UL	VPC	TUV	CCC	VDE	Others
39R102A	6.25	10	370	4285	1255	480	8.93	2.61	39-07						
39R122A	7.0	10	370	4800	1405	535	8.97	2.63	39-07						
39R132A	7.5	15	370	5120	1500	495	10.34	3.03	39-01		○				
39R132B	7.5	15	370	5180	1515	495	10.46	3.06	39-08						KC
39R142A	8.1	15	370	5515	1615	530	10.41	3.05	39-01	○	○				
39R162A	9.75	20	370	6665	1950	655	10.18	2.98	39-01	○	○				Inmetro
39R162B	9.5	8	400	6585	1930	725	9.08	2.66	39-02		○				
39R162C	9.75	20	370	6725	1970	655	10.27	3.01	39-01						Inmetro
39R172B	10.4	20	370	7105	2080	700	10.15	2.97	39-01	○	○				KC, Inmetro
39R192A	11.1	25	370	7660	2245	760	10.08	2.95	39-01		○				
39R202A	11.4	25	370	7855	2300	760	10.34	3.03	39-01	○	○				KC, Inmetro
44R202A	11.4	30	370	7775	2280	745	10.44	3.06	44-02	○	○				
44R212A	12.4	30	370	8450	2475	805	10.50	3.07	44-02	○	○				
44R232A	13.2	25	370	8930	2615	840	10.63	3.11	44-02	○	○				KC, Inmetro
44R232B	13.2	25	370	9165	2685	850	10.78	3.16	44-02						Inmetro
44R232C	13.2	30	370	9145	2680	865	10.57	3.10	44-07						
44R2D2C	13.5	30	370	9345	2735	880	10.62	3.11	44-07						Inmetro
44R252A	14.7	30	370	10120	2965	960	10.54	3.09	44-02	○	○				Inmetro
44R262A	15.6	30	370	10635	3115	1005	10.58	3.10	44-02	○	○				
44R282A	16.4	30	370	11270	3300	1065	10.58	3.10	44-02	○	○				
44R292A	16.8	30	370	11585	3395	1095	10.58	3.10	44-02	○	○				Inmetro
44R312A	18.1	30	370	12540	3670	1185	10.58	3.10	44-02	○	○				Inmetro
44R312B	18.1	30	370	12660	3705	1190	10.64	3.11	44-02						
44R332A	19.1	30	370	13330	3905	1260	10.58	3.10	44-02	○	○				
48R342C	19.2	35	370	13690	4010	1290	10.61	3.11	48-02		○				
48R362A	20.2	35	370	14225	4165	1365	10.42	3.05	48-02	○	○				
48R372A	20.8	40	370	14565	4265	1410	10.33	3.02	48-02	○	○				
48R382B	21.4	40	370	15355	4495	1450	10.59	3.10	48-02	○	○				
48R422A	23.5	40	370	16430	4810	1560	10.53	3.08	48-02	○	○				
48R442A	25.0	40	370	17560	5140	1660	10.58	3.10	48-02	○	○				Inmetro
48R462B	25.8	35	370	18450	5405	1770	10.42	3.05	48-02	○	○				
48R462W	25.8	40	370	18215	5335	1715	10.62	3.11	48-03						KC
48R492A	27.1	40	370	19365	5670	1880	10.30	3.02	48-02	○	○				Inmetro
48R502A	28.0	40	370	19720	5775	1930	10.22	2.99	48-02	○	○				
48R562A	32.5	40	370	22775	6670	2270	10.03	2.94	48-07		○				
48R612A	34.0	40	370	24205	7090	2420	10.00	2.93	48-07	○	○				Inmetro
50R492P	27.1	45	370	19085	5590	1810	10.54	3.09	50-08	○	○				
50R492V	27.1	45	370	19085	5590	1810	10.54	3.09	50-08						
50R502P	28.0	45	370	19600	5740	1870	10.48	3.07	50-08	○	○				
50R552V	31.6	50	370	22140	6485	2100	10.54	3.09	50-08	○	○				CB
50R572P	32.5	50	370	22775	6670	2220	10.26	3.00	50-08						
50R572V	32.5	50	370	22775	6670	2220	10.26	3.00	50-08	○	○				
50R642V	35.6	45	400	25395	7435	2450	10.37	3.03	50-08						
55R762G	41.6	50	400	30435	8915	2890	10.53	3.08	55-01						Inmetro

R22 1Φ 220-240V / 50Hz

Testing Condition : ASHRAE/T

Model	Disp. c.c.	Capacitor		Cooling Capacity		Input Power W	EER Btu/h.W	COP W/W	Outline Drawing	Safety Recognition					
		μF	VAC	Btu/h	W					C-UL	VPC	TUV	CCC	VDE	Others
39R123B	8.1	20	370	4485	1315	445	10.08	2.96	39-01			○	○		
39R143C	10.4	20	370	5835	1710	590	9.89	2.90	39-01			○	○		
39R163B	11.1	20	370	6310	1850	630	10.02	2.94	39-01			○	○		
39R173A	11.4	25	370	6470	1895	650	9.95	2.92	39-01				○		
44R173A	12.4	40	370	6905	2020	665	10.38	3.04	44-02			○			
44R173B	12.4	25	370	6825	2000	670	10.19	2.99	44-02			○			
44R193A	13.2	40	370	7340	2150	700	10.49	3.07	44-02			○	○		
44R193B	13.2	25	370	7260	2125	705	10.30	3.01	44-02			○			
44R203A	14.7	40	370	8175	2395	780	10.48	3.07	44-02			○	○		
44R203B	14.7	25	370	8135	2380	805	10.11	2.96	44-02			○	○		
44R213A	15.6	40	370	8730	2555	835	10.46	3.06	44-02			○	○		
44R213B	15.6	25	370	8690	2545	860	10.10	2.96	44-02			○	○		
44R213C	15.6	25	370	8690	2545	840	10.35	3.03	44-02			○	○		
44R233A	16.4	40	370	9125	2675	880	10.37	3.04	44-02			○			
44R233B	16.4	25	370	9085	2660	895	10.15	2.97	44-02			○	○		
44R233C	16.4	25	370	9125	2675	880	10.37	3.04	44-02			○	○		
44R233J	16.4	25	370	9125	2675	880	10.37	3.04	44-04			○	○		
44R243B	16.8	25	370	9405	2755	930	10.11	2.96	44-02			○	○		
44R243C	16.8	25	370	9365	2740	905	10.35	3.03	44-02			○	○		
44R243J	16.8	25	370	9365	2740	905	10.35	3.03	44-04			○	○		
44R253A	18.1	35	370	10160	2975	980	10.37	3.04	44-02			○	○		
44R253B	17.5	25	370	9840	2880	990	9.94	2.91	44-02			○	○		
44R253C	17.5	35	370	9840	2880	960	10.25	3.00	44-02			○	○		
44R253J	17.5	35	370	9840	2880	960	10.25	3.00	44-04			○	○		
44R273A	19.1	35	370	10715	3135	1055	10.16	2.97	44-02			○	○		
48R293N	20.2	30	370	11705	3430	1125	10.40	3.05	48-03			○			
48R313A	21.4	30	370	12500	3660	1230	10.16	2.98	48-02			○	○		CB
48R313N	21.4	30	370	12540	3670	1230	10.20	2.98	48-03			○	○		
48R313P	21.4	30	420	12540	3670	1180	10.63	3.11	48-03			○	○		
48R313U	21.4	30	370	12540	3670	1230	10.20	2.98	48-03			○	○		
48R313V	21.4	30	370	12540	3670	1180	10.63	3.11	48-03			○	○		
48R323A	22.2	25	370	12815	3755	1250	10.25	3.00	48-02			○	○		CB
48R323N	22.2	30	370	12895	3775	1250	10.32	3.02	48-03			○	○		
48R323P	22.2	30	420	13015	3810	1230	10.58	3.10	48-03			○	○		
48R323U	22.2	30	370	12895	3775	1250	10.32	3.02	48-03			○	○		
48R323V	22.2	30	370	13015	3810	1230	10.58	3.10	48-03			○	○		
48R343A	23.5	30	370	13690	4010	1320	10.37	3.04	48-02			○	○		CB
48R343N	23.5	30	370	13750	4025	1330	10.34	3.03	48-03			○	○		
48R343P	23.5	30	420	13750	4025	1300	10.58	3.10	48-03			○	○		
48R343U	23.5	30	370	13750	4025	1330	10.34	3.03	48-03			○	○		
48R343V	23.5	30	370	13750	4025	1300	10.58	3.10	48-03			○	○		
48R363N	25.0	30	370	14565	4265	1415	10.29	3.01	48-03						
48R363V	25.0	30	370	14600	4275	1390	10.50	3.08	48-03			○	○		
48R373A	25.8	30	370	15000	4390	1530	9.80	2.87	48-02			○			CB



**R22 1Φ 220-240V / 50Hz**

Testing Condition : ASHRAE/T

Model	Disp.			Capacitor		Cooling Capacity		Input Power		EER	COP	Outline Drawing	Safety Recognition					
	c.c.	μF	VAC	Btu/h	W	W	Btu/h.W	W/W	C-UL				VPC	TUV	CCC	VDE	Others	
48R403A	27.1	30	370	15830	4635	1585	9.99	2.92	48-02								CB	
48R413A	28.0	30	370	16350	4785	1645	9.94	2.91	48-02								CB	
48R433A	29.2	30	370	16945	4960	1660	10.21	2.99	48-07								CB	
48R433N	29.2	30	370	16945	4960	1660	10.21	2.99	48-08									
48R433U	29.2	30	370	16945	4960	1660	10.21	2.99	48-08									
48R453A	30.6	35	370	17735	5195	1800	9.85	2.89	48-07								CB	
48R453N	30.6	35	370	17735	5195	1800	9.85	2.89	48-08									
48R453U	30.6	35	370	17735	5195	1800	9.85	2.89	48-08									
48R473A	32.5	35	370	18850	5520	1900	9.92	2.91	48-07								CB	
48R473N	32.5	35	370	18850	5520	1900	9.92	2.91	48-08									
48R473V	32.5	35	370	18650	5460	1820	10.25	3.00	48-08									
48R483V	33.3	35	370	19045	5580	1875	10.16	2.98	48-08									
48R493G	34.0	35	370	19680	5765	2000	9.84	2.88	48-07									
50R433V	29.2	35	400	16665	4880	1570	10.61	3.11	50-08								TIS	
50R453V	30.6	35	370	17540	5135	1680	10.44	3.06	50-08									
50R453Y	30.6	35	370	17695	5185	1650	10.72	3.14	50-08									
50R473V	32.5	35	370	18690	5475	1810	10.33	3.02	50-08									
50R493V	34.0	40	400	19485	5705	1920	10.15	2.97	50-08									
50R503V	34.7	45	400	19920	5835	1960	10.16	2.98	50-08									
55R573G	39.0	40	400	22220	6505	2140	10.38	3.04	55-03									
55R613G	41.6	40	450	24205	7090	2330	10.39	3.04	55-01									
55R613H	41.6	40	450	24205	7090	2330	10.39	3.04	55-02									
55R653G	44.2	45	450	25595	7495	2470	10.36	3.03	55-01									
55R683G	46.5	45	450	26745	7830	2590	10.33	3.02	55-01									
55R683U	46.5	45	450	26745	7830	2590	10.33	3.02	55-03									
55R713G	48.6	50	450	28175	8250	2730	10.32	3.02	55-01									
55R713U	48.6	50	450	28175	8250	2730	10.32	3.02	55-03									

**R22 1Φ 200-220V / 50Hz**

Testing Condition : ASHRAE/T

Model	Disp.			Capacitor		Cooling Capacity		Input Power		EER	COP	Outline Drawing	Safety Recognition					
	c.c.	μF	VAC	Btu/h	W	W	Btu/h.W	W/W	C-UL				VPC	TUV	CCC	VDE	Others	
39R094A	6.25	20	370	3490	1025	365	9.56	2.81	39-06									
39R114A	7.5	15	370	4285	1255	415	10.33	3.02	39-06									
39R1C4C	8.6	20	370	4840	1420	520	9.31	2.73	39-08									
39R164A	11.1	25	370	6230	1825	625	9.97	2.92	39-01									
44R194A	13.2	25	370	7460	2185	730	10.22	2.99	44-02									
44R204A	14.7	35	370	8410	2465	785	10.71	3.14	44-02								TIS	
44R214A	15.6	25	370	8690	2545	840	10.35	3.03	44-02									
44R214D	15.6	25	370	8830	2585	900	9.81	2.87	44-01									
44R234G	16.4	35	370	9085	2660	895	10.15	2.97	44-02									
48R274P	19.2	30	370	11190	3275	1050	10.66	3.12	48-03									
50R454U	30.6	40	370	17775	5205	1780	9.99	2.92	50-08									

**R22 1Φ 100/100-110V 50/60Hz**

Testing Condition : ASHRAE/T

Model	Disp.			Capacitor		Cooling Capacity		Input Power		EER	COP	Outline Drawing	Safety Recognition					
	c.c.	μF	VAC	Btu/h	W	W	Btu/h.W	W/W	C-UL				VPC	TUV	CCC	VDE	Others	
39R165B	50Hz	9.5	80	200	5355	1570	540	9.92	2.91	39-01								
					6430	1880	635	10.13	2.96									
39R165C	50Hz	9.5	25	250	5275	1545	605	8.72	2.55	39-02								
					6430	1880	710	9.06	2.65									
39R175C	50Hz	10.4	40	250	5835	1710	600	9.73	2.85	39-01								
					7025	2055	720	9.76	2.85									
39R175D	50Hz	10.4	60	250	5910	1730	625	9.46	2.77	39-01								
					7105	2080	705	10.08	2.95									

**R22 1Φ 265V / 60Hz**

Testing Condition : ASHRAE/T

Model	Disp.			Capacitor		Cooling Capacity		Input Power		EER	COP	Outline Drawing	Safety Recognition					
	c.c.	μF	VAC	Btu/h	W	W	Btu/h.W	W/W	C-UL				VPC	TUV	CCC	VDE	Others	
44R217A	12.4	25	370	8390	2460	805	10.42	3.06	44-02									
44R287A	16.4	30	370	11470	3360	1100	10.43	3.05	44-02									



典型应用：中国高效空调机  
Typical Application: China Hi-EER Air-Conditioner

**R22 1Φ 220-240V / 50Hz**

Testing Condition : ASHRAE/T  
MAT

Model	Disp.			Capacitor		Cooling Capacity		Input Power		EER	COP	Outline Drawing	Safety Recognition					
	c.c.	μF	VAC	Btu/h	W	W	Btu/h.W	W/W	C-UL				VPC	TUV	CCC	VDE	Others	
44S183A	13.2	35	370	7620	2230	710	10.73	3.14	44-02									
				9565	2800	580	16.49	4.83										
44S193A	14.0	35	370	7955	2330	750	10.61	3.11	44-02									
				10100	2955	610	16.56	4.84										
44S203A	14.7	35	370	8335	2440	785	10.62	3.11	44-02								TIS	
				10595	3105	640	16.55	4.85										
44S213A	15.6	35	370	8810	2580	835	10.55	3.09	44-02									
				11150	3265	675	16.52	4.84										
44S213G	15.6	35	370	8810	2580	835	10.55	3.09	44-02									
				11150	3265	675	16.52	4.84										
48S273V	19.2	30	370	11070	3240	995	11.13	3.26	48-03									
				14085	4125	825	17.07	5.00										
48S283V	19.7	30	370	11350	3325	1020	11.13	3.26	48-03									
				14445	4230	845	17.09	5.01										
50S273W	19.2	30	370	11270	3300	1020	11.05	3.24	50-03									
				14365	4205	845	17.00	4.98										
50S293W	20.2	30	370	11825	3465	1060	11.16	3.27	50-03									
				15040	4405	875	17.19	5.03										
50S303W	20.8	30	370	12180	3565	1090	11.17	3.27	50-03								TIS	
				15395	4510	895	17.20	5.04										
50S313W	21.4	30	370	12420	3635	1115	11.14	3.26	50-03									
				15755	4615	920	17.13	5.02										



**R22 1Φ 220-240V / 50Hz**

Testing Condition : ASHRAE/T MAT

Model	Disp. c.c.	Capacitor		Cooling Capacity		Input Power		EER	COP	Outline Drawing	Safety Recognition					
		μF	VAC	Btu/h	W	W	Btu/h.W				W/W	C-UL	VPC	TUV	CCC	VDE
50S433Y	29.2	35	400	16825	4925	1570	10.72	3.14	50-08							
				21530	6305	1260	17.09	5.00								
50S443Y	29.9	35	400	17230	5045	1610	10.70	3.13	50-08							
				22045	6455	1290	17.09	5.00								
50S453Y	30.6	40	370	17540	5135	1640	10.70	3.13	50-08							
				22420	6565	1320	16.98	4.97								

**T** 典型应用: 热带(T3)空调机  
Typical Application: Tropical (T3) Air-Conditioner

**R22 1Φ 208-230V / 60Hz**

Testing Condition : ASHRAE/T

Model	Disp. c.c.	Capacitor		Cooling Capacity		Input Power		EER	COP	Outline Drawing	Safety Recognition					
		μF	VAC	Btu/h	W	W	Btu/h.W				W/W	C-UL	VPC	TUV	CCC	VDE
48T502A	28.0	40	370	19680	5765	1980	9.94	2.91	48-07							
48T502G	28.0	40	370	19680	5765	1980	9.94	2.91	48-07							
50T502U	28.0	50	370	19720	5775	1930	10.22	2.99	50-08							
50T512Y	28.6	50	370	20235	5925	1900	10.65	3.12	50-08							
55T532G	35.6	35	450	20475	5995	1950	10.50	3.07	55-01							
55T682G	37.6	55	400	27180	7960	2700	10.07	2.95	55-01							

**R22 1Φ 220-240V / 50Hz**

Testing Condition : ASHRAE/T

Model	Disp. c.c.	Capacitor		Cooling Capacity		Input Power		EER	COP	Outline Drawing	Safety Recognition					
		μF	VAC	Btu/h	W	W	Btu/h.W				W/W	C-UL	VPC	TUV	CCC	VDE
44T233G	16.4	35	370	9425	2760	895	10.53	3.08	44-04							
48T313G	21.4	30	370	12540	3670	1230	10.20	2.98	48-02							
48T313N	21.4	30	370	12540	3670	1230	10.20	2.98	48-03							
48T313U	21.4	30	370	12540	3670	1230	10.20	2.98	48-03							
48T323A	22.2	30	370	12815	3755	1250	10.25	3.00	48-02							
48T323G	22.2	30	370	12815	3755	1250	10.25	3.00	48-02							
48T323N	22.2	30	370	12895	3775	1260	10.23	3.00	48-03							
48T473U	32.5	40	370	18570	5440	1930	9.62	2.82	48-08							
50T453U	30.6	40	370	17935	5250	1790	10.02	2.93	50-08							
50T473U	32.5	40	370	18850	5520	1900	9.92	2.91	50-08							
50T493U	34.0	50	370	19800	5800	1960	10.10	2.96	50-08							
50T503U	34.7	50	370	20040	5870	1990	10.07	2.95	50-08							
55T613G	41.6	45	450	24205	7090	2315	10.46	3.06	55-01							
55T653G	44.2	45	450	25595	7495	2470	10.36	3.03	55-01							
55T683G	46.5	55	450	26745	7830	2590	10.33	3.02	55-01							
55T683U	46.5	55	450	26745	7830	2590	10.33	3.02	55-03							

**工作/测试工况 Working / Testing Condition**

	冷凝温度 °C Condensing temp	蒸发温度 °C Evaporating temp	膨胀阀前温度 °C Liquid temp	吸入温度 °C Suction temp	环境温度 °C Ambient temp
ASHRAE/T	54.4	7.2	46.1	35	35
MAT	45	12	40	24	35
CHEER	37.8	7.2	29.5	18.3	35
HPD	70	25	61	35	35
HPWH	65	10	55	20	35

**接线图 Wiring Diagram**

**PCS Type (General)**

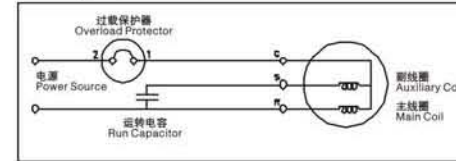

**DC Inverter Type 1**

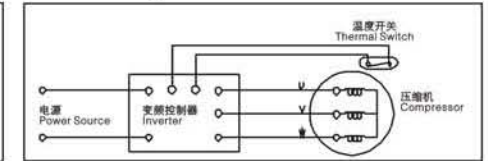

**Int. Overload Protector Type**

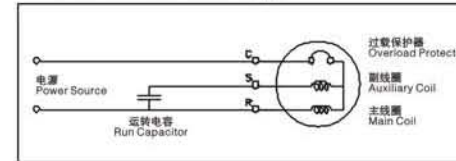

**DC Inverter Type 2**

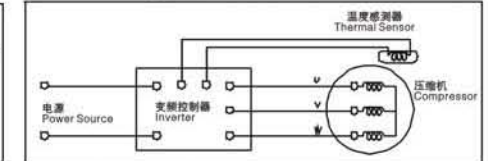

**Dual Overload Protector**

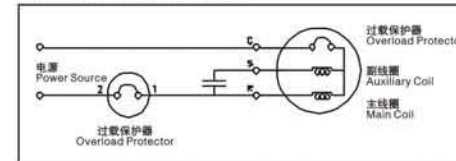

外观图/Outline Drawing

39-01,02,03,04,06,07,08,09,10,26

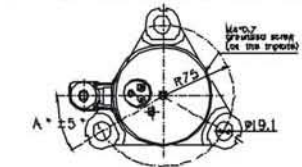

39-01,03,06,07,08(b)

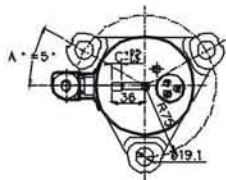

44-01,02,04,05,06,07,09,10

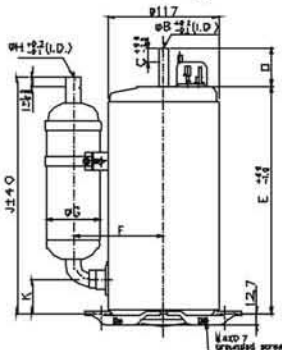
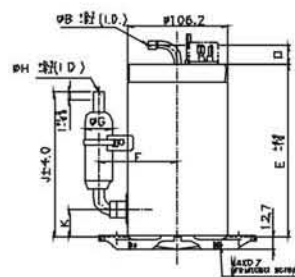
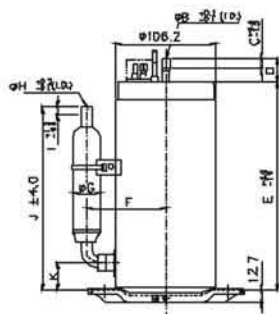
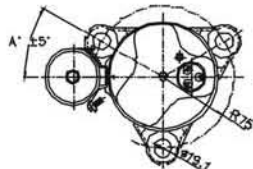

44-02(b)

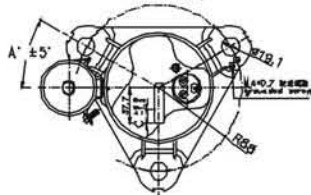

44-02(c)

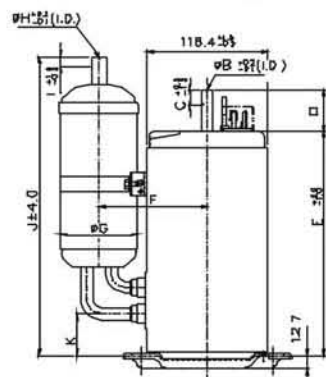
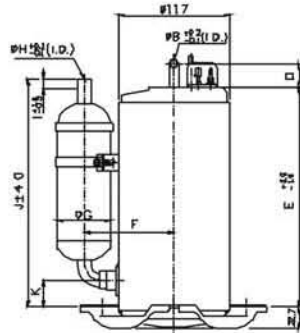
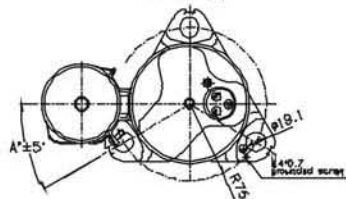

外观图/Outline Drawing

48-01,02,03,07,08

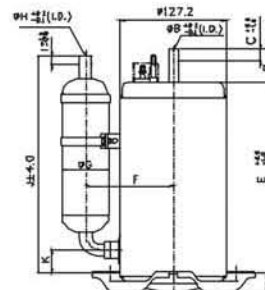
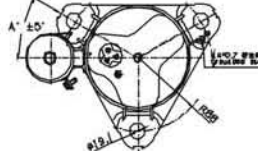

50-03,04,08

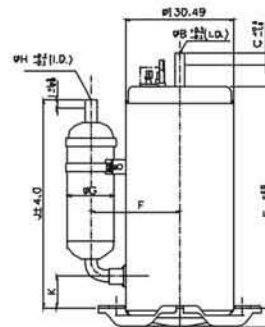
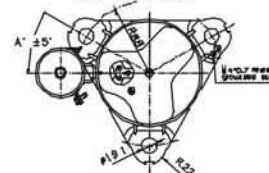

50-02(b)

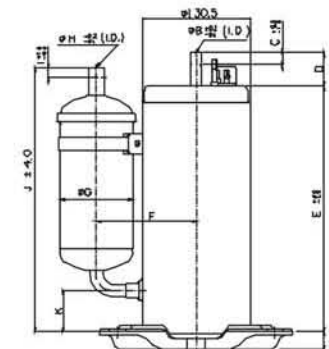
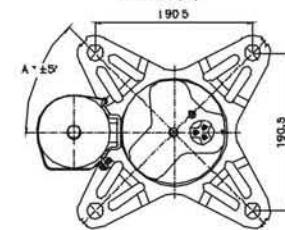

55-01,02,04

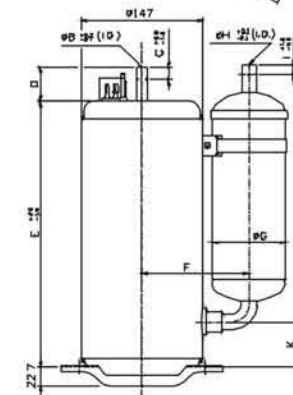
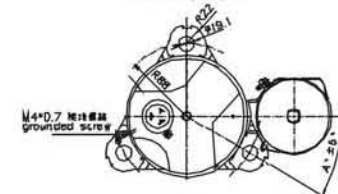

### 外观图尺寸/Dimensions Table for Outline Drawing

Fig.No	A	B	C	D	E	F	G	H	I	J	K
39-01	±30/60	6.5/8.1	10.5/14.5	24.3	220.3	84	28.6	9.7	8	193.5	29.5
39-01	±30/60	6.5/8.1	10.5/14.5	40	220.3	87	40	9.7	8	193.5	29.5
39-01(b)	±30/60	6.5	10.5	21	220.3	84	28.6	9.7	8	193.5	29.5
39-02	±30/60	8.1	14.5	40	192.9	84	28.6	9.7	8	153.5	29.5
39-03	±30/60	6.5	10.5	24.3	182.9	84	28.6	9.7	8	153.5	29.5
39-03(b)	±30/60	6.5	10.5	21	182.9	84	28.6	9.7	8	153.5	29.5
39-04	±30/60	8.1	14.5	24.3	202.9	84	28.6	9.7	8	153.5	29.5
39-06	±30/60	6.5/8.1	10.5/14.5	24.3	220.3	84	28.6	9.7	8	191	27
39-06	±30/60	6.5/8.1	10.5/14.5	24.3	220.3	87	40	9.7	8	191	27
39-06	±30/60	6.5	10.5	24.3	220.3	90	57	9.7	8	242.5	27
39-06	±30/60	6.5	10.5	24.3	220.3	90	57	9.7	8	297	27
39-06(b)	±30/60	6.5	10.5	21	220.3	84/87	28.6/40	9.7	8	191	27
39-07	±30/60	6.5	10.5	24.3	174.9	84	28.6	9.7	8	191	27
39-07	±30/60	6.5	10.5	24.3	174.9	84	28.6	9.7	8	151	27
39-07	±30/60	6.5	10.5	24.3	174.9	87	40	9.7	8	191	27
39-07(b)	±30/60	6.5	10.5	21	174.9	84	28.6	9.7	8	151	27
39-08	±30/60	6.5	10.5	24.3	198.9	84	28.6	9.7	8	151	27
39-08	±30/60	6.5	10.5	24.3	198.9	84	28.6	9.7	8	191	27
39-08(b)	±30/60	6.5	10.5	21	198.9	84	28.6	9.7	8	191	27
39-09	±30/60	6.5	10.5	24.3/40	209.9	84	28.6	9.7	8	191	27
39-09	±30/60	6.5	10.5	24.3/40	209.9	87	40	9.7	8	191	27
39-10	±30/60	8.1	14.5	24.3/40	240.3	90	57.3	12.8	10	312	42
39-10	±30/60	8.1	14.5	24.3/40	240.3	99.8	75	12.8	8	264	42
39-26	±30/60	6.5/8.1	10.5/14.5	24.3	182.9	84	28.6	9.7	8	151	27
44-01	±30/60	8.1	14.5	24	224.8	92	28	12.8	10	219.8	35.8
44-01	±30/60	8.1	14.5	24	224.8	91	48	12.8	10	219.8	35.8
44-02	±30/60	8.1	14.5	24/40	239.8	94	40	9.7	8	248.8	35.8
44-02	±30/60	8.1	14.5	24/40	239.8	91	48	12.8	10	219.8/248.8	35.8
44-02	±30/60	8.1	14.5	24/40	239.8	91	48	9.7	8	248.8	35.8
44-02	±30/60	8.1	14.5	24/40	239.8	96	57.3	9.7	8	248.8	35.8
44-02	±30/60	8.1	14.5	24/40	239.8	96	57.3	12.8	10	248.8/270.8/305.8	35.8
44-02	±30/60	8.1	14.5	24/40	239.8	105.2	75	12.8	10	257.8	35.8
44-02(b)	±30/60	8.1	14.5	25	239.8	96	57.3	12.8	10	241.1	28.1
44-02(c)	±30/60	8.1	14.5	40	219.8	105.9	75	12.8	10	292.9	40.9

### 外观图尺寸/Dimensions Table for Outline Drawing

Fig.No	A	B	C	D	E	F	G	H	I	J	K
44-04	±30/60	8.1	14.5	24	244.8	91	48	9.7	8	248.8	35.8
44-05	±30/60	8.1	14.5	24	249.8	91	48	9.7	8	248.8	35.8
44-05	±30/60	8.1	14.5	40	249.8	105.2	75	12.8	10	267.8	35.8
44-06	±30/60	8.1	14.5	40	249.8	96	57.3	12.8	10	280.8	45.8
44-06	±30/60	8.1	14.5	40	249.8	105.2	75	12.8	10	267.8	45.8
44-07	±30/60	8.1	14.5	24/40	239.8	94	40	9.7	8	244.1	31.1
44-07	±30/60	8.1	14.5	24/40	239.8	91	48	9.7/12.8	8/10	244.1/215.1	31.1
44-07	±30/60	8.1	14.5	24/40	239.8	96	57.3	9.7/12.8	8/10	244.1	31.1
44-09	±30/60	8.1	14.5	24	229.8	96	57.3	9.7	8	254.1	41.1
44-10	±30/60	8.1	14.5	24	249.8	105.2	75	12.8	8	263.1	41.1
48-01	±30/60	8.1	14.5	40.6	221.9	105	57.3	9.7	10	241.1	28.1
48-02	±30/60	8.1	14.5	40.6	231.4	96	48	12.8	10	241.1	28.1
48-02	±30/60	8.1/9.7	14.5	40.6	231.4	105	57.3	12.8/15.9	10	263.1	28.1
48-02	±30/60	8.1/9.7	14.5	40.6	231.4	114	75	12.8	10	250.1	28.1
48-03	±30/60	8.1	14.5	40.6	266.5	105	57.3	12.8	10	251.1/273.1	38.1
48-03	±30/60	8.1/9.7	14.5	40.6	266.5	105	57.3	15.9	12	273.1	38.1
48-03	±30/60	8.1/9.7	14.5	40.6	266.5	114	75	12.8	10	260.1	38.1
48-07	±30/60	9.7	14.5	40.6	260.5	114	75	12.8/15.9	12	284.9	32.9
48-08	±30/60	9.7	14.5	40.6	295.5	114	75	15.9	12	299.9/332.9	47.9
50-03	±30/60	8.1/9.7	14.5	24/40.6	266.5	107	57	12.8	10	251.1/273.1	38.1
50-03	±30/60	8.1/9.7	14.5	24/40.6	266.5	112	75	12.8/15.9	10/12	260.1/290.1	38.1
50-04	±30/60	9.7	14.5	40	295.5	120.8	89	15.9	12	318.1	48.1
50-04(b)	45	9.7	14.5	40	296.2	120.8	89	15.9	12	318.1	48.1
50-08	±30/60	9.7	14.5	24/40	295.5	112	75	12.8/15.9	10/12	299.9	47.9
50-08	±30/60	9.7	14.5	24/40.6	295.5	112	75	15.9	12	332.9	47.9
50-08	±30/60	9.7	14.5	24/40.6	295.5	120.8	89	15.9	12	317.9	47.9
55-01	±30/60	9.7	14.5	40.6	321.2	120	75	15.9	12	339.8	54.8
55-01	±30/60	9.7	14.5	40.6	321.2	129	89	15.9	12	365	54.8
55-02	±30/60	9.7	14.5	24	306.2	129	89	15.9	12	324.8	54.8
55-04	±30/60	9.7	14.5	24	321.2	129	89	15.9	12	324.8	54.8

## 马达简介 / Motor Introduction

瑞智制冷机器(东莞)有限公司是瑞智集团的子公司, 具有行业领先的马达开发设计技术和先进的生产设备。主要生产各种类型的马达及水泵, 产品广泛应用于除湿机、空调、冰箱、冰柜等产品的压缩机上。

Rechi Refrigeration (DongGuan) Co Ltd is the subsidiary company of Rechi Group, it has leading and state of art motors design and R&D technology and with advanced machinery for motors manufacturing. We manufacture various series and many types of motors for Water Pump, Dehumidifier, Air-conditioner, Home & commercial Refrigerator Compressor usage.

## 销售网络 / Sales Network



## 先进的检测设备 / Advanced Tester



生产车间  
Production floor



马达动力测试机  
CMT Motor Tester



定子测试机  
Stator Tester



寿命测试机  
Air stall Tester

## 马达 / Motor

### 主要产品 / Main Products

#### 马达铁芯系列 / Motor Stator Cores Series

我司采用“Zig-Zag”连续冲切和自铆型堆叠技术生产定转子铁芯, 能有效管控硅钢片的冲切品质、降低物料损耗、提升产能。此技术可极大满足客户对品质与量的需求。

Rechi adores and uses "Zig-Zag" Blanking with automatic continuous feeding punch presses and with auto stacking technology to produce Stator and Rotor core for Motors. As such, it enable us to provide and control good punching lamination quality, less scarp and waste. And best for production capacity as well. It can fulfill and satisfy customer QUALITY and QUANTITY requirement.

#### 马达系列 / Motor Series



#### DC 变频马达系列 / DC Motor Series



#### 马达系列参数 Motor Series Specifications

马达系列 Motor Series	型号 MODEL	内径 (") ID (#)	外径 (") OD (#)	功率 Hp
AC 系列 AC Series	39 frame	1.922	3.981	0.5-1.0
		2.007	3.981	0.5-1.0
	44 frame	2.208	4.418	1.0-1.5
	48 frame	2.400	4.791	1.5-2.5
	50 frame	2.400	4.921	1.5-2.5
	53 frame	2.650	5.733	1.5-3.5
	53 frame	2.650	6.480	2.0-3.5
DC 系列 DC Series	59frame(1ph)	2.650	6.480	2.0-3.5
	59frame(3ph)	2.650	6.480	2.0-3.5
	39 frame	2.208	3.981	1.0-1.5
	44 frame	2.400	4.416	1.5-2.0

#### 水泵系列 / Water Pump Motor Series



#### 水泵系列参数 Water Pump Motor Series Specifications

水泵系列 Water Pump Motor Series	功率 Hp	长 (") Length	宽 (") Width	高 (") Height
ES009X	0.50	8.42	6.15	8.50
ES011X	0.75	9.21	6.15	8.50
ES004X	1.00	10.00	6.15	8.50
ES006X	1.00	9.60	6.15	8.50
ES003X	1.50	10.55	6.15	8.50
ES007X	1.50	10.55	6.15	8.50
ES013X	1.50	10.39	6.15	8.50

### 变频控制器/Inverter Controller

为了成为保护地球并减少全球暖化的一分子，瑞智精密除了积极于变频压缩机的研究创新开发外，并致力于专业DC变频控制器之研究开发，研发团队内专业人才于相关领域皆有10多年以上的资历，除此之外，多年来瑞智精密也与各相关单位进行密切的合作关系，积极开发出更好的产品，这全为了能让电机马达与电子控制器紧密的结合，进而提供给客户更具竞争力的产品。

In order to become a part of protectors who protects and reduces the global warming. Rechi is devoted to research and developing the compressors and Air-conditioner inverter. The members in the researching team of the inverter have more than 10 years of experience in this field. Besides, Rechi has cooperated with several inverter researching institutes. We make the inverter have the compact combination with the DC motors, and then offer the more competitive product to our customers.

### 瑞智DC变频产品的优势/Rechi's inverter product advantage

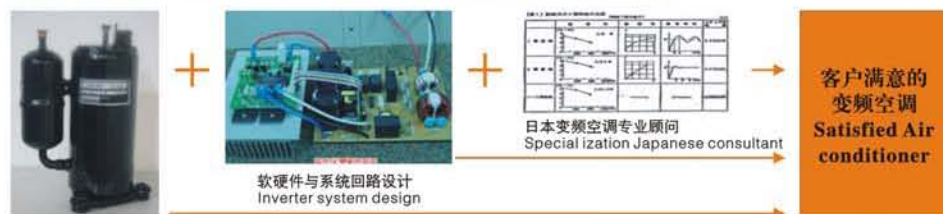

DC变频压缩机的选用  
Recommend the compressor

瑞智为客户提供完整的DC变频空调所需的解决方案  
RECHI supplies the total solution for DC inverter air-conditioner

### 产品特色/Product characteristics:

项目 Items	说明 Contents
直流电机驱动功能 DC motor drive function	低成本直流电机驱动。 Low cost DC motor driver.
180° 正弦波驱动方案 180° sine waves drive function	低压缩机震动。 Low compressor vibration. 低压缩机噪音。 Low compressor noise. 高压缩机效率。 High compressor efficiency.
弱磁控制 Weak magnetic control	增加压缩机稳定度。 Increase compressor stability. 降低控制器成本。 Reduce the cost of control device.
力矩控制 Torque control	抑制压缩机震动。 Restrain compressor vibration.
软启动控制 Soft start-up control	减低压缩机启动时震动及噪音。 Lower vibration and noise during compressor starting. 提高压缩机使用寿命。 Increase compressor life time.
客制化设计 Customized design	硬件方面：可依客户机体的设计，对控制器做出最合适尺寸以及最齐全的功能。 Hardware: Customized design for the suitable size and functions. 软件方面：可依消费者使用习惯，做出最佳化设计，可依客户所需功能，进行调整开发。 Software: Optimized design in accordance with consumer's operation habit. Design in accordance with customer's required functions.
全方面服务 services	专业空调系统人员及实验室，协助客户进行系统调整验证。 Air-conditioning system experts and laboratories to assist customer for system testing and adjustment. 专业EMI测试仪器，协助客户进行预先安规认证测试，减短取得相关证书的时间。 EMI test instrument to assist customer to obtain the relevant certificate.

### 瑞智与他牌控制器之震动抑制能力比较表/Vibration control comparison chart with other brands

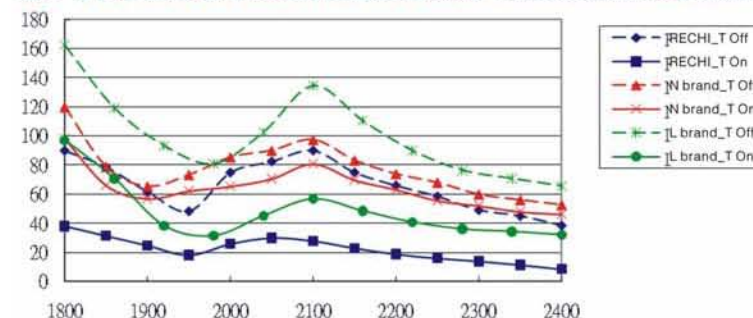

### 产品规格/Product specification:

Voltage(single phase)	Frequency	Capacity
187Vac-253Vac	50/60Hz	2.2KW / 7500BTU
187Vac-253Vac	50/60Hz	2.8KW / 9000BTU
187Vac-253Vac	50/60Hz	3.6KW / 12000BTU
187Vac-253Vac	50/60Hz	4.1KW / 14000BTU
187Vac-253Vac	50/60Hz	5.2KW / 18000BTU
187Vac-253Vac	50/60Hz	6.3KW / 21000BTU
187Vac-253Vac	50/60Hz	7.2KW / 24500BTU

### 缩短客户DC变频空调设计时程

#### /Shorten customer's inverter air-conditioner design period

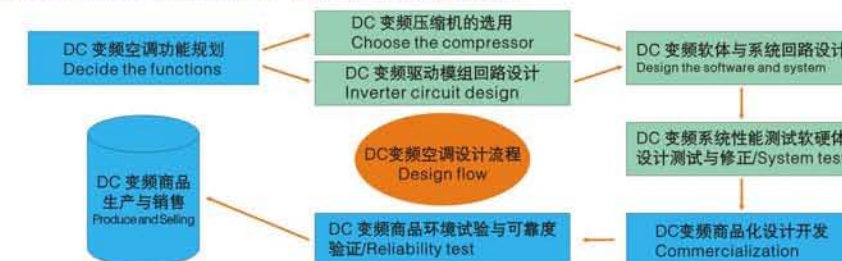

■ 客户工作 Customer job  
■ 瑞智提供服务，包括开发阶段之测试治具及空调生产之检测治具  
Rechi job, with the testing tool for design stage and the checking tool for producing the air conditioner.