

# BA-300/300S\* 1/4"-3"

**Bronze Ball Valve**  
**Three Piece**  
**Full Port**  
**600 WOG/150 SWP (1)**  
**Threaded Ends**  
**Blow-Out Proof Stem**  
**MSS SP-110**

\*Not intended for use in potable water.

## MATERIALS LIST

| ITEM | PART          | MATERIALS               | ASTM SPEC. |
|------|---------------|-------------------------|------------|
| 1    | Body          | Cast Bronze             | B584       |
| 2    | End Cap       | Bronze                  | B584       |
| 3    | Stem          | Brass                   | B16        |
|      |               | 316 Stainless Steel (2) | A276       |
| 4    | Packing Nut   | Brass                   | B16        |
| 5    | Packing       | PTFE                    |            |
| 6    | Thrust Washer | RPTFE, 25% Glass Filled |            |
| 7    | Ball          | CP Brass                | B16        |
|      |               | 316 Stainless Steel (2) | A276       |
| 8    | Seat          | RPTFE, 15% Glass Filled |            |
| 9    | O-Ring        | Viton                   | Commercial |
| 10   | Handle        | Steel w/Zinc Plating    | Commercial |
| 11   | Handle Grip   | Vinyl                   | Commercial |
| 12   | Handle Nut    | Steel w/Zinc Plating    | Commercial |
| 13   | Bolt          | Steel w/Zinc Plating    | Commercial |
| 14   | Nut           | Steel w/Zinc Plating    | Commercial |

(1) Milwaukee Valve Company recommends the use of Stainless Steel ball and stem for steam applications. Please consult factory for more information.

(2) Ball and stem are stainless for 300S

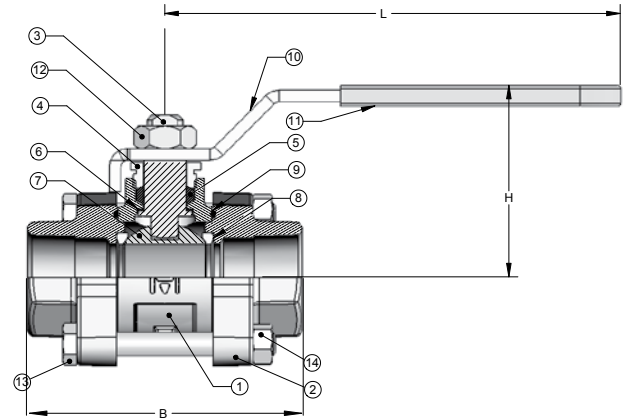

## PRESSURE and TEMPERATURE CHART

VALVES RATED FOR VACUUM SERVICE TO 29 INCHES Hg.

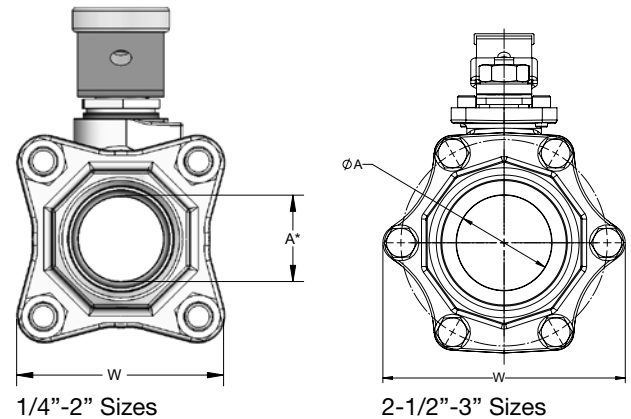
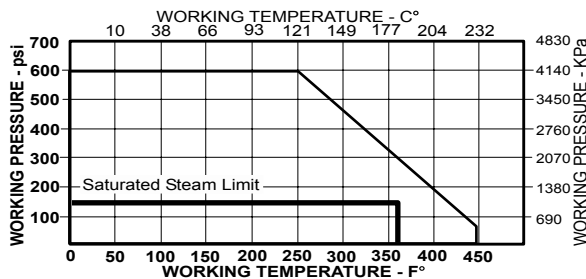

1/4"-2" Sizes

2-1/2"-3" Sizes

## DIMENSIONS

|    | UNITS       | 1/4"<br>DN6 | 3/8"<br>DN10 | 1/2"<br>DN15 | 3/4"<br>DN20 | 1"<br>D25 | 1-1/4"<br>D32 | 1-1/2"<br>D40 | 2"<br>D50 | 2-1/2"<br>DN 65 | 3" *<br>DN 80 |
|----|-------------|-------------|--------------|--------------|--------------|-----------|---------------|---------------|-----------|-----------------|---------------|
| A  | INCHES      | 0.50        | 0.50         | 0.50         | 0.75         | 1         | 1.25          | 1.50          | 2.00      | 2.50            | 2.50          |
|    | mm          | 13          | 13           | 13           | 19           | 25        | 32            | 38            | 51        | 64              | 64            |
| B  | INCHES      | 3.03        | 3.03         | 3.03         | 3.65         | 3.82      | 4.86          | 5.06          | 6.00      | 7.00            | 7.00          |
|    | mm          | 77          | 77           | 77           | 90           | 97        | 123           | 129           | 152       | 178             | 178           |
| H  | INCHES      | 1.65        | 1.65         | 1.65         | 2.24         | 2.65      | 2.86          | 3.03          | 3.26      | 4.09            | 4.09          |
|    | mm          | 42          | 42           | 42           | 57           | 67        | 73            | 77            | 83        | 104             | 104           |
| L  | INCHES      | 4.03        | 4.03         | 4.06         | 4.58         | 6.30      | 6.32          | 7.20          | 7.20      | 8.00            | 8.00          |
|    | mm          | 102         | 102          | 103          | 116          | 160       | 161           | 183           | 183       | 203             | 203           |
| W  | INCHES      | 1.95        | 1.95         | 1.95         | 2.19         | 2.48      | 3.00          | 3.13          | 3.78      | 6.25            | 6.25          |
|    | mm          | 50          | 50           | 50           | 56           | 63        | 76            | 80            | 96        | 159             | 159           |
| F  | THREAD SIZE | 1/4" NPT    | 3/8" NPT     | 1/2" NPT     | 3/4" NPT     | 1" NPT    | 1-1/4" NPT    | 1-1/2" NPT    | 2" NPT    | 2-1/2" NPT      | 3" NPT        |
| Cv |             | 7           | 7            | 17           | 31           | 60        | 110           | 185           | 360       | 390             | 390           |

Note: DN (Diameter Nominal) = Metric equivalent size.

\* 3" is Standard Port.

The information presented on this sheet is correct at the time of publication. Milwaukee Valve reserves the right to change design, and/or material specifications without notice. For the Installation, Operation and Maintenance Manual (IOM) see the Technical/Service Information section on our website. For the most current information access [www.milwaukeevalve.com](http://www.milwaukeevalve.com)

