

## **FEATURES**

- Up to 10.0 EER cooling efficiency
- Less than 1.4% cabinet air leakage
- Completely self-contained heating and cooling package
  - No outside condensing unit
  - No external refrigerant lines
  - No separate cooling coil
- Pre-wired and pre-charged
- Individually metered and controlled
- Easy service access
- Louver color options to match building facade
- Available with optional factory installed Ventilation Air Kit
- Available with no electric heat
- Available with Climate Guard™ optional epoxy coated evaporator and condenser coils
- Available with optional Miami-Dade rated impact resistant louvers

## **REFRIGERANT SYSTEM**

- R410A Refrigerant
- High efficiency compressor
- Copper tubing with enhanced fin coils

## **CABINET**

- Fully insulated cabinet for quiet operation
- Anti-microbial insulation in all air handling compartments

## **BLOWER**

- Four-speed permanently lubricated PSC motor for low maintenance, maximum efficiency and wide airflow range
- Dynamically balanced blower with resilient motor mounts for smooth and quiet operation
- Internal washable filter

## **CONTROLS**

- Color coded wiring for easy service
- Fuse protection on 24V circuit
- No heat models include 24V output to control external heat source

## **INSTALLATION**

- Easy to install and service
- Louver mounts flush to outside wall
- Wind load certification up to 186 mph\*

## **WARRANTY**

- 5 year limited warranty on all parts



\*See Magic-Pak M-Series™ and V-Series™ - 2014 Florida Building Code Wind Load Calculations (available on [www.magic-pak.com/](http://www.magic-pak.com/) literature within the installation instructions link) for specifics.

### MODEL NUMBER GUIDE

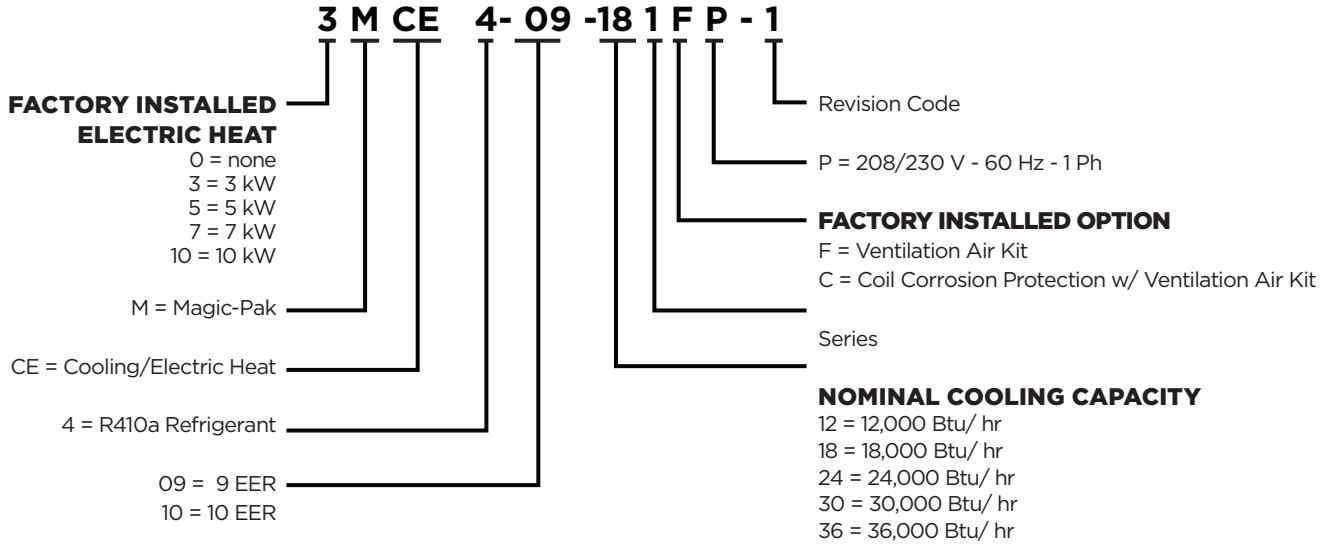

### ELECTRICAL AND PHYSICAL DATA

Model	Voltage/ Hz/Phase	Voltage Range	Min. Circuit Ampacity		Maximum Fuse/ HACR Breaker		Compressor		Outside Fan				Indoor Blower			R410A Refrig. Charge (oz.)	Weight (lbs.)
			208V	230V	208V	230V	Rated Load Amps	Locked Rotor Amps	Dia. (in.)	Nom. RPM	Rated Load Amps	Rated HP	Wheel dia. x width (in.)	Rated Load Amps	Rated HP		
0MCE4-09-121*P	208-230/60/1	197 - 253	---	11	---	15	6.8	45	16	1075	0.9	1/8	9 x 6	1.6	1/4	44	201
3MCE4-09-121*P			19	21	20	25											
5MCE4-09-121*P			24	27	25	30											
7MCE4-09-121*P			35	40	40	40											
0MCE4-09-181*P	208-230/60/1	197 - 253	---	15	---	25	9.6	43	16	1075	0.9	1/8	9 x 6	1.6	1/4	44	204
3MCE4-09-181*P			19	21	20	25											
5MCE4-09-181*P			24	27	25	30											
7MCE4-09-181*P			35	40	40	40											
10MCE4-09-181*P			46	52	50	60											
0MCE4-09-241*P	208-230/60/1	197 - 253	---	19	---	30	13.5	58	18	1075	0.9	1/8	9 x 6	1.6	1/4	54	210
5MCE4-09-241*P			24	27	30	30											
7MCE4-09-241*P			35	40	40	40											
10MCE4-09-241*P			46	52	50	60											
0MCE4-09-301*P	208-230/60/1	197 - 253	---	21	---	30	14.1	73	18	1075	1.6	1/4	9 x 7	1.9	1/3	61	218
5MCE4-09-301*P			24	28	30	30											
7MCE4-09-301*P			35	40	40	40											
10MCE4-09-301*P			46	53	50	60											
0MCE4-09-361*P	208-230/60/1	197 - 253	---	27	---	40	17.9	112	18	1075	1.6	1/4	10 x 7	2.7	1/2	103	255
5MCE4-09-361*P			27	29	40	40											
7MCE4-09-361*P			36	41	40	45											
10MCE4-09-361*P			46	54	50	60											

0MCE4-10-181*P	208-230/60/1	197 - 253	---	15	---	25	9.6	43	18	1075	0.9	1/8	9 x 6	1.6	1/4	70	222
3MCE4-10-181*P			19	21	20	25											
5MCE4-10-181*P			24	27	30	30											
7MCE4-10-181*P			35	40	40	40											
10MCE4-10-181*P			46	52	50	60											
0MCE4-10-241*P	208-230/60/1	197 - 253	---	19	---	30	13.5	58	18	1075	0.9	1/8	9 x 6	1.6	1/4	80	227
5MCE4-10-241*P			24	27	30	30											
7MCE4-10-241*P			35	40	40	40											
10MCE4-10-241*P			46	52	50	60											
0MCE4-10-301*P	208-230/60/1	197 - 253	---	21	---	30	14.1	73	18	1075	1.6	1/4	9 x 7	1.9	1/3	102	251
5MCE4-10-301*P			24	28	30	30											
7MCE4-10-301*P			35	40	40	40											
10MCE4-10-301*P			46	53	50	60											

**BLOWER PERFORMANCE**

Model	Blower Speed	CFM @ ext. static pressure - in. w.c. with filter				
		0.1	0.2	0.3	0.4	0.5
MCE4-09-121*P MCE4-09-181*P MCE4-09-241*P	Low	450	440	425	400	370
	Medium Low	700	690	680	650	600
	Medium High	810	800	790	770	730
	High	940	920	875	850	810
MCE4-09-301*P	Low	620	600	580	560	535
	Medium Low	840	820	785	750	700
	Medium High	975	940	870	825	760
	High	1075	1000	930	880	800
MCE4-09-361*P	Low	750	720	680	650	620
	Medium Low	1000	980	950	920	880
	Medium High	1100	1080	1050	1020	980
	High	1270	1230	1200	1170	1130

MCE4-10-181*P MCE4-10-241*P	Low	450	440	425	400	370
	Medium Low	700	690	680	650	600
	Medium High	810	800	790	770	730
	High	940	920	875	850	810
MCE4-10-301*P	Low	630	620	610	580	550
	Medium Low	900	890	850	800	750
	Medium High	1070	1030	1000	920	840
	High	1220	1150	1100	1030	920

**ELECTRIC HEAT DATA**

Model	Input Voltage								
	240			230			208		
	kW/Hr	Btuh	Amps	kW/Hr	Btuh	Amps	kW/Hr	Btuh	Amps
3kW	3.60	12,284	15.00	3.31	11,281	14.38	2.70	9,226	13.00
5kW	4.80	16,378	20.00	4.41	15,042	19.17	3.61	12,302	17.33
7kW	7.20	24,567	30.00	6.61	22,563	28.75	5.41	18,453	26.00
10kW	9.60	32,757	40.00	8.82	30,084	38.33	7.21	24,604	34.67

**PERFORMANCE**

Model	Cooling			CFM	Electric Heat @ 240V	
	Btuh	EER	S/T		kW/Hr	Btuh
0MCE4-09-121*P	12,000	9.0	.77	450	N/A	N/A
3MCE4-09-121*P					3.6	12,200
5MCE4-09-121*P					4.8	16,300
7MCE4-09-121*P					7.2	24,500
0MCE4-09-181*P	17,200	9.0	.73	600	N/A	N/A
3MCE4-09-181*P					3.6	12,200
5MCE4-09-181*P					4.8	16,300
7MCE4-09-181*P					7.2	24,500
10MCE4-09-181*P					9.6	32,700
0MCE4-09-241*P	22,400	9.0	.76	800	N/A	N/A
5MCE4-09-241*P					4.8	16,300
7MCE4-09-241*P					7.2	24,500
10MCE4-09-241*P					9.6	32,700
0MCE4-09-301*P	27,400	9.0	.74	900	N/A	N/A
5MCE4-09-301*P					4.8	16,300
7MCE4-09-301*P					7.2	24,500
10MCE4-09-301*P					9.6	32,700
0MCE4-09-361*P	35,000	9.0	.70	1100	N/A	N/A
5MCE4-09-361*P					4.8	16,300
7MCE4-09-361*P					7.2	24,500
10MCE4-09-361*P					9.6	32,700

0MCE4-10-181*P	18,000	10.0	.74	600	N/A	N/A
3MCE4-10-181*P					3.6	12,200
5MCE4-10-181*P					4.8	16,300
7MCE4-10-181*P					7.2	24,500
10MCE4-10-181*P					9.6	32,700
0MCE4-10-241*P	22,400	10.0	.76	800	N/A	N/A
5MCE4-10-241*P					4.8	16,300
7MCE4-10-241*P					7.2	24,500
10MCE4-10-241*P					9.6	32,700
0MCE4-10-301*P	28,400	10.0	.74	1000	N/A	N/A
5MCE4-10-301*P					4.8	16,300
7MCE4-10-301*P					7.2	24,500
10MCE4-10-301*P					9.6	32,700

### COOLING PERFORMANCE EXTENDED RATINGS

Model	Indoor Temp DB/ WB °F	Outdoor Temperature - DB °F														
		65			85			95			105			115		
		Btuh	S/T	kW	Btuh	S/T	kW	Btuh	S/T	kW	Btuh	S/T	kW	Btuh	S/T	kW
MCE4-09-121P	85/72	13,600	.57	1.16	12,900	.62	1.28	12,400	.65	1.37	11,600	.70	1.46	10,900	.74	1.42
	80/67	13,100	.65	1.15	12,700	.71	1.28	12,000	.77	1.33	9,800	.74	1.38	9,400	.88	1.40
	75/63	12,600	.89	1.14	11,400	.75	1.26	10,600	.79	1.32	9,500	.86	1.37	8,300	.92	1.37
	75/57	11,400	1.00	1.13	10,900	1.00	1.23	10,700	1.00	1.30	9,500	1.00	1.36	8,400	1.00	1.37
MCE4-09-181P	85/72	21,100	.57	1.59	19,200	.61	1.79	17,900	.64	1.93	16,400	.68	2.02	14,900	.72	2.03
	80/67	20,600	.64	1.57	19,200	.70	1.79	17,200	.73	1.91	15,500	.77	1.99	13,200	.84	1.99
	75/63	18,300	.68	1.56	16,300	.74	1.73	14,900	.79	1.85	13,100	.85	1.93	11,400	.90	1.93
	75/57	17,800	1.00	1.54	16,400	1.00	1.73	15,300	1.00	1.87	13,500	1.00	1.95	11,700	1.00	1.95
MCE4-09-241P	85/72	26,700	.61	1.92	25,300	.66	2.26	24,400	.69	2.53	22,900	.72	2.81	21,400	.75	2.84
	80/67	25,200	.69	1.90	24,300	.73	2.23	22,600	.77	2.51	21,100	.79	2.73	18,900	.85	2.83
	75/63	23,900	.74	1.87	21,700	.78	2.19	20,200	.81	2.44	18,300	.86	2.72	16,500	.90	2.77
	75/57	21,900	1.00	1.86	20,800	1.00	2.20	20,100	1.00	2.46	18,400	1.00	2.73	16,800	1.00	2.77
MCE4-09-301P	85/72	33,700	.60	2.40	31,400	.63	2.80	29,700	.66	3.10	27,800	.69	3.41	25,900	.71	3.39
	80/67	31,500	.67	2.37	29,800	.71	2.73	27,600	.74	3.07	25,300	.77	3.36	22,800	.82	3.34
	75/63	29,300	.72	2.34	26,900	.75	2.73	21,100	.77	3.03	22,700	.82	3.33	20,300	.86	3.31
	75/57	27,400	1.00	2.32	25,800	1.00	2.71	24,600	1.00	3.00	22,400	1.00	3.30	20,300	1.00	3.27
MCE4-09-361P	85/72	41,000	.56	2.91	38,600	.58	3.47	36,700	.60	3.90	34,900	.63	4.29	33,100	.66	4.38
	80/67	39,100	.63	2.89	37,000	.67	3.43	35,000	.70	3.89	32,500	.70	4.16	30,100	.76	4.35
	75/63	37,200	.67	2.88	32,100	.70	3.38	31,700	.73	3.76	29,400	.77	4.14	27,200	.80	4.23
	75/57	34,000	1.00	2.83	32,400	1.00	3.39	31,200	1.00	3.81	28,900	1.00	4.18	26,800	1.00	4.26

MCE4-10-181P	85/72	22,400	.55	1.44	21,100	.60	1.63	20,200	.64	1.78	18,100	.69	1.87	16,000	.73	1.89
	80/67	21,200	.63	1.42	20,600	.67	1.63	18,000	.73	1.76	16,100	.77	1.82	13,100	.86	1.84
	75/63	20,400	.66	1.42	18,300	.72	1.57	16,700	.76	1.70	13,800	.85	1.78	11,000	.93	1.79
	75/57	18,400	1.00	1.39	17,000	1.00	1.58	16,000	1.00	1.72	13,800	1.00	1.80	11,700	1.00	1.80
MCE4-10-241P	85/72	28,600	.60	1.67	26,400	.64	1.96	24,800	.67	2.18	23,000	.70	2.41	21,100	.73	2.41
	80/67	27,200	.67	1.66	24,700	.72	1.93	22,600	.76	2.17	20,300	.75	2.37	18,800	.82	2.39
	75/63	25,500	.71	1.65	22,800	.75	1.93	20,800	.78	2.14	18,700	.82	2.36	16,600	.86	2.37
	75/57	23,700	1.00	1.63	21,600	1.00	1.91	20,100	1.00	2.13	18,500	1.00	2.34	16,700	1.00	2.34
MCE4-10-301P	85/72	35,300	.62	2.18	32,000	.67	2.55	29,500	.71	2.82	28,200	.72	3.11	26,800	.73	3.13
	80/67	33,200	.70	2.17	30,700	.73	2.51	28,600	.76	2.80	25,300	.81	3.04	24,000	.83	3.10
	75/63	31,100	.74	2.15	28,300	.76	2.48	26,200	.78	2.73	23,900	.83	3.03	21,600	.87	3.08
	75/57	28,900	1.00	2.13	26,900	1.00	2.48	25,500	1.00	2.74	23,400	1.00	3.02	21,400	1.00	3.04

## ACCESSORIES

Description	Kit Number	Where Used
Polypropylene Louver Kit (White)	ALVRPWHT-1	MCE4-09 (12, 18, 24, 30) / MCE4-10 (18, 24)
Polypropylene Louver Kit (White)	ALVRPWHT-2	MCE4-09-36 / MCE4-10-30
Polypropylene Louver Kit (Sandstone)	ALVRPSAN-1	MCE4-09 (12, 18, 24, 30) / MCE4-10 (18, 24)
Polypropylene Louver Kit (Sandstone)	ALVRPSAN-2	MCE4-09-36 / MCE4-10-30
Polypropylene Louver Kit (Beige)	ALVRPBGE-1	MCE4-09 (12, 18, 24, 30) / MCE4-10 (18, 24)
Polypropylene Louver Kit (Beige)	ALVRPBGE-2	MCE4-09-36 / MCE4-10-30
Polypropylene Louver Kit (Taupestone)	ALVRPTST-1	MCE4-09 (12, 18, 24, 30) / MCE4-10 (18, 24)
Polypropylene Louver Kit (Taupestone)	ALVRPTST-2	MCE4-09-36 / MCE4-10-30
Extruded Aluminum Louver Kit	ALVRAL-1	MCE4-09 (12, 18, 24, 30) / MCE4-10 (18, 24)
Extruded Aluminum Louver Kit (Custom Color**)	ALVRAL-1P	MCE4-09 (12, 18, 24, 30) / MCE4-10 (18, 24)
Extruded Aluminum Louver Kit	ALVRAL-2	MCE4-09-36 / MCE4-10-30
Extruded Aluminum Louver Kit (Custom Color**)	ALVRAL-2P	MCE4-09-36 / MCE4-10-30
Extruded Aluminum Louver Kit (45" height louver)	ALVRAL-3	MCE4-09 (12, 18, 24, 30) / MCE4-10 (18, 24)
Extruded Aluminum Louver Kit (45" height louver)	ALVRAL-4	MCE4-09-36 / MCE4-10-30
Extruded Aluminum Louver Kit (Impact Rated)	ALVRALC-1	MCE4-09 (12, 18, 24, 30) / MCE4-10 (18, 24)
Extruded Aluminum Louver Kit (Impact Rated / Custom Color**)	ALVRALC-1P	MCE4-09 (12, 18, 24, 30) / MCE4-10 (18, 24)
Extruded Aluminum Louver Kit (Impact Rated)	ALVRALC-2	MCE4-09-36 / MCE4-10-30
Extruded Aluminum Louver Kit (Impact Rated / Custom Color**)	ALVRALC-2P	MCE4-09-36 / MCE4-10-30
Wall Sleeve Kit (45" Louver)	ASLEEVE-3*	MCE4-09 (12, 18)
2" Wall Sleeve Kit	ASLEEVE2-1	MCE4-09 (12, 18, 24, 30) / MCE4-10 (18, 24)
2" Wall Sleeve Kit	ASLEEVE2-2	MCE4-09-36 / MCE4-10-30
6" Wall Sleeve Kit	ASLEEVE6-1	MCE4-09 (12, 18, 24, 30) / MCE4-10 (18, 24)
6" Wall Sleeve Kit	ASLEEVE6-2	MCE4-09-36 / MCE4-10-30
6" Wall Sleeve for 45" Louver	ASLEEVE6-3	MCE4-09 (12, 18, 24, 30) / MCE4-10 (18, 24)
6" Wall Sleeve for 45" Louver	ASLEEVE6-4	MCE4-09-36 / MCE4-10-30
8" Wall Sleeve Kit	ASLEEVE8-1	MCE4-09 (12, 18, 24, 30) / MCE4-10 (18, 24)
8" Wall Sleeve Kit	ASLEEVE8-2	MCE4-09-36 / MCE4-10-30
8" Wall Sleeve for 45" Louver	ASLEEVE8-3	MCE4-09 (12, 18, 24, 30) / MCE4-10 (18, 24)
8" Wall Sleeve for 45" Louver	ASLEEVE8-4	MCE4-09-36 / MCE4-10-30
10" Wall Sleeve Kit	ASLEEVE10-1	MCE4-09 (12, 18, 24, 30) / MCE4-10 (18, 24)
10" Wall Sleeve Kit	ASLEEVE10-2	MCE4-09-36 / MCE4-10-30
10" Wall Sleeve for 45" Louver	ASLEEVE10-3	MCE4-09 (12, 18, 24, 30) / MCE4-10 (18, 24)
10" Wall Sleeve for 45" Louver	ASLEEVE10-4	MCE4-09-36 / MCE4-10-30
12" Wall Sleeve Kit	ASLEEVE12-1	MCE4-09 (12, 18, 24, 30) / MCE4-10 (18, 24)
12" Wall Sleeve Kit	ASLEEVE12-2	MCE4-09-36 / MCE4-10-30
12" Wall Sleeve for 45" Louver	ASLEEVE12-3	MCE4-09 (12, 18, 24, 30) / MCE4-10 (18, 24)
12" Wall Sleeve for 45" Louver	ASLEEVE12-4	MCE4-09-36 / MCE4-10-30
Threaded PVC Nipple	AADAPTVC-1	All MCE's
Wall Sleeve Extension Kit	ASLEEVEEXT 4-1, 4-2	A SLEEVE WALL KITS (only with 1 & 2, cannot use with 3 & 4)

\*Thru the wall applications only.

\*\* Customer specified color.

**ACCESSORIES DIMENSIONS (IN.)**

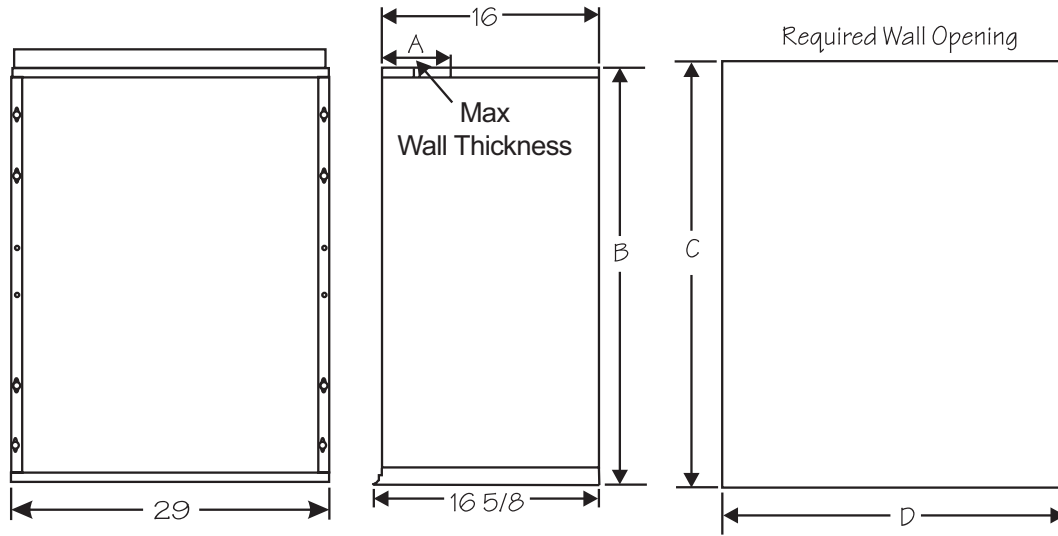

**ACCESSORIES**

Kit Number	A	B	C	D
ASLEEVE2-1	2	29	29-1/8	29-1/8
ASLEEVE2-2	2	32-3/4	32-7/8	29-1/8
ASLEEVE6-1	6	29	29-1/8	29-1/8
ASLEEVE6-2	6	32-3/4	32-7/8	29-1/8
ASLEEVE6-3*	6	45	45-1/8	29-1/8
ASLEEVE6-4*				
ASLEEVE8-1	8	29	29-1/8	29-1/8
ASLEEVE8-2	8	32-3/4	32-7/8	29-1/8
ASLEEVE8-3*	8	45	45-1/8	29-1/8
ASLEEVE8-4*				
ASLEEVE10-1	10	29	29-1/8	29-1/8
ASLEEVE10-2	10	32-3/4	32-7/8	29-1/8
ASLEEVE10-3*	10	45	45-1/8	29-1/8
ASLEEVE10-4*				
ASLEEVE12-1	12	29	29-1/8	29-1/8
ASLEEVE12-2	12	32-3/4	32-7/8	29-1/8
ASLEEVE12-3*	12	45	45-1/8	29-1/8
ASLEEVE12-4*				
ASLEEVE-3	*	45	45-1/8	29-1/8

\*45" wall opening installations only. 6" wall depth or less. Cannot use with MGE's.



**DIMENSIONS (IN.)**

Model	A	B	C	D	E	F
MCE4-09-121*P	43-7/8	16-7/8	25-5/16	21-1/2	18-5/8	19-1/4
MCE4-09-181*P						
MCE4-09-241*P	47-13/16	18-15/16	27-1/8	24-3/8	20-5/8	21-3/16
MCE4-09-301*P						
MCE4-09-361*P	55-13/16	22-13/16	31-1/8	24-3/8	24-3/4	25-1/16
MCE4-10-181*P	47-13/16	18-15/16	27-1/8	24-3/8	20-5/8	21-3/16
MCE4-10-241*P						
MCE4-10-301*P	55-13/16	22-13/16	31-1/8	24-3/8	24-3/4	25-1/16

**OUTDOOR SOUND RATINGS**

Model	Sound Rating (dBA)
MCE4-09-121*P	72
MCE4-09-181*P	
MCE4-09-241*P	74
MCE4-09-301*P	76
MCE4-09-361*P	
MCE4-10-181*P	74
MCE4-10-241*P	74
MCE4-10-301*P	76

Per ANSI/AHRI Standard 270

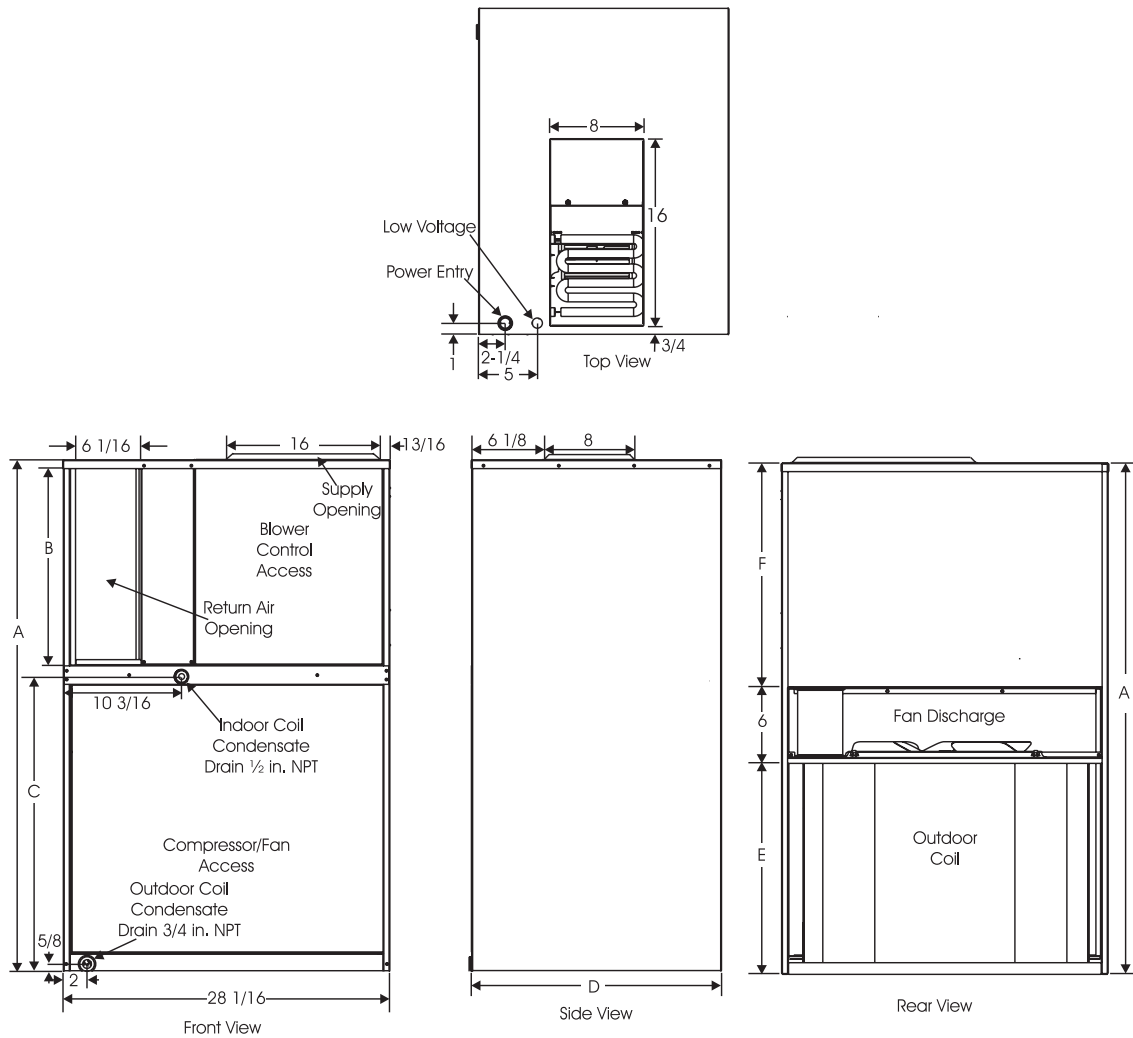

Revisions		
Section	Page #	Description
Electrical and Physical Data	2	added 0MCE4-10-181P, 0MCE4-10-241P, 0MCE4-10-301P
Performance	4	added 0MCE4-10-181P, 0MCE4-10-241P, 0MCE4-10-301P



215 Metropolitan Drive | West Columbia, SC 29170  
800-448-5872  
Product Support 866-282-7257

All specifications and illustrations subject to change without notice and without incurring obligations.